



Keypad



RFID



TABLE OF CONTENTS**QR Code Sticker Placement**

QR Code Overview & IMPORTANT: Before Installation.....	3
--	---

Surface Keypad Installation - Surface Mount: For Door Thickness up to 25mm

Required Components & Installation	4
3-Hole Template	5
Recommended Tools for Installation	5
Installation-Concealed Plate.....	6
4-Hole Template-Concealed Plate.....	7

Recess Keypad Installation - Recess Mount: For Door Thickness between 10-25mm

Required Components & Installation	8
Recess Mortise Template	9
Recommended Tools for Installation	9
Installation-Concealed Plate.....	10
4-Hole Template-Concealed Plate.....	11

Surface RFID Installation - Surface Mount: For Door Thickness up to 25mm

Required Components & Installation	12
3-Hole Template	13
Recommended Tools for Installation	13
Installation-Concealed Plate.....	14
4-Hole Template-Concealed Plate.....	15

Recess RFID Installation - Recess Mount: For Door Thickness between 10-25mm

Required Components & Installation	16
Recess Mortise Template	17
Recommended Tools for Installation	17
Installation-Concealed Plate.....	18
Mortise Template-Concealed Plate	19

Surface Keypad Installation - Surface Mount: For Door Thickness less than 10mm

Required Components & Installation	20
3-Hole Template	21
Recommended Tools for Installation	21
Installation-Concealed Plate.....	22
4-Hole Template-Concealed Plate.....	23

Recess Keypad Installation - Recess Mount: For Door Thickness less than 10mm

Required Components & Installation	24
Recess Mortise Template	25
Recommended Tools for Installation	25
Installation-Concealed Plate.....	26
Recess Mortise Template-Concealed Plate.....	27

Surface RFID Installation - Surface Mount: For Door Thickness less than 10mm

Required Components & Installation	28
3-Hole Template	29
Recommended Tools for Installation	29
Installation-Concealed Plate.....	30
4-Hole Template-Concealed Plate.....	31

Recess RFID Installation - Recess Mount: For Door Thickness less than 10mm

Required Components & Installation	32
Recess Mortise Template	33
Recommended Tools for Installation	33
Installation-Concealed Plate.....	34
Mortise Template-Concealed Plate	35

QR CODE STICKER PLACEMENT

A QR Code sticker is provided for initial setup to initialize locks to the DigiLink system.

QR Code Overview

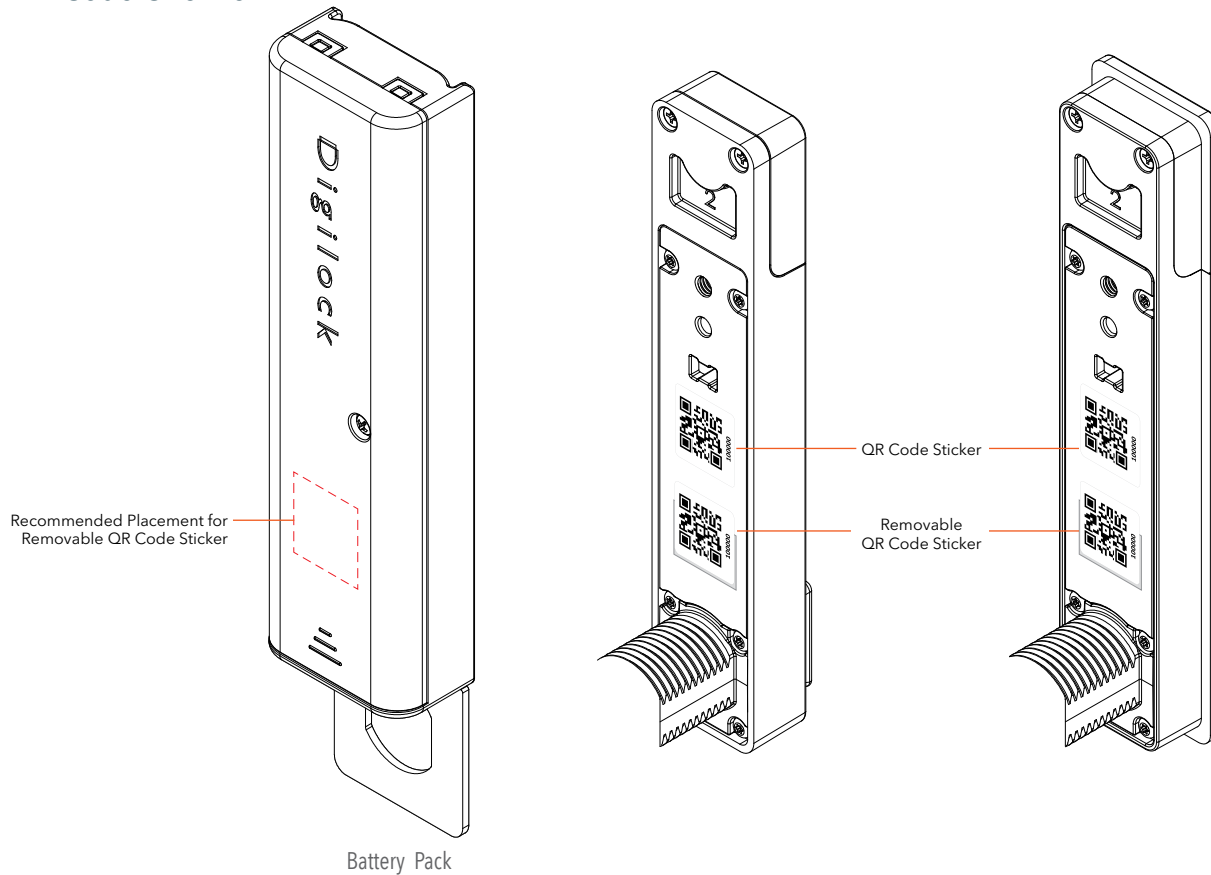

IMPORTANT: Before Installation

A pair of identical QR code stickers unique to each lock are attached to the back of the front unit. Before installation, one of these stickers must be attached to the lock's battery pack so that it may be easily scanned when adding the lock to DigiLink.

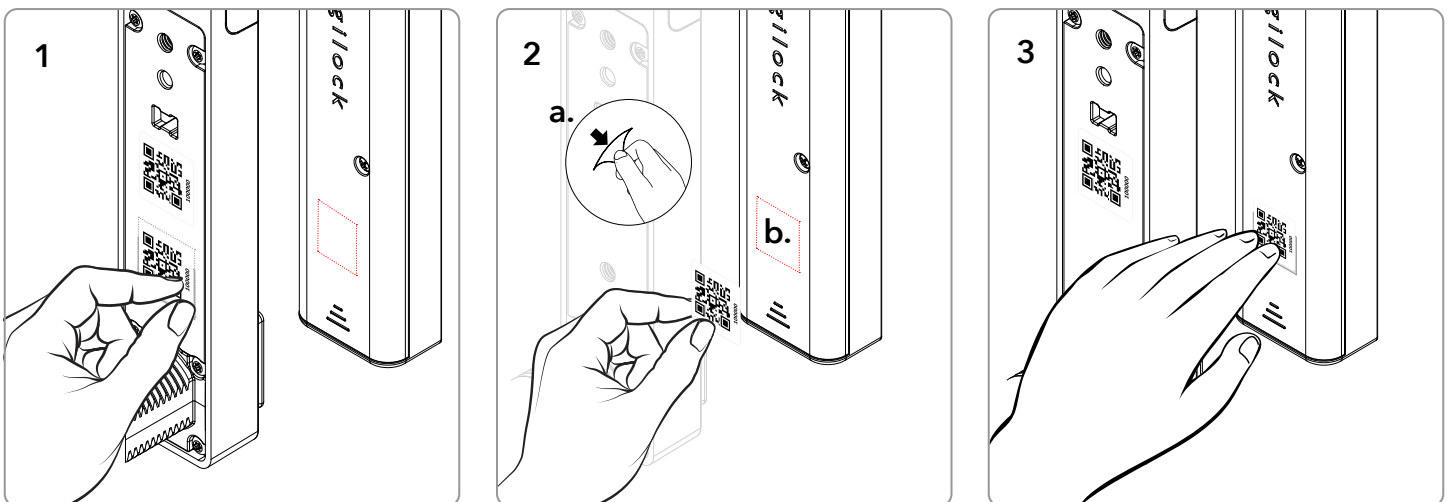

1. Before installation, remove the partially attached QR code sticker located on the back of the front unit.

2a. Remove the tab from the back of the QR code sticker.
2b. Attach the QR code sticker to the front of the battery pack in the location shown above.

3. Make sure the QR code sticker is securely attached to the battery pack and visible when the lock is installed.

Note: The QR code sticker on the battery pack MUST match the QR code sticker on the front unit.

SURFACE KEYPAD INSTALLATION

Surface Mount: For Door Thickness up to 25mm

Required Components

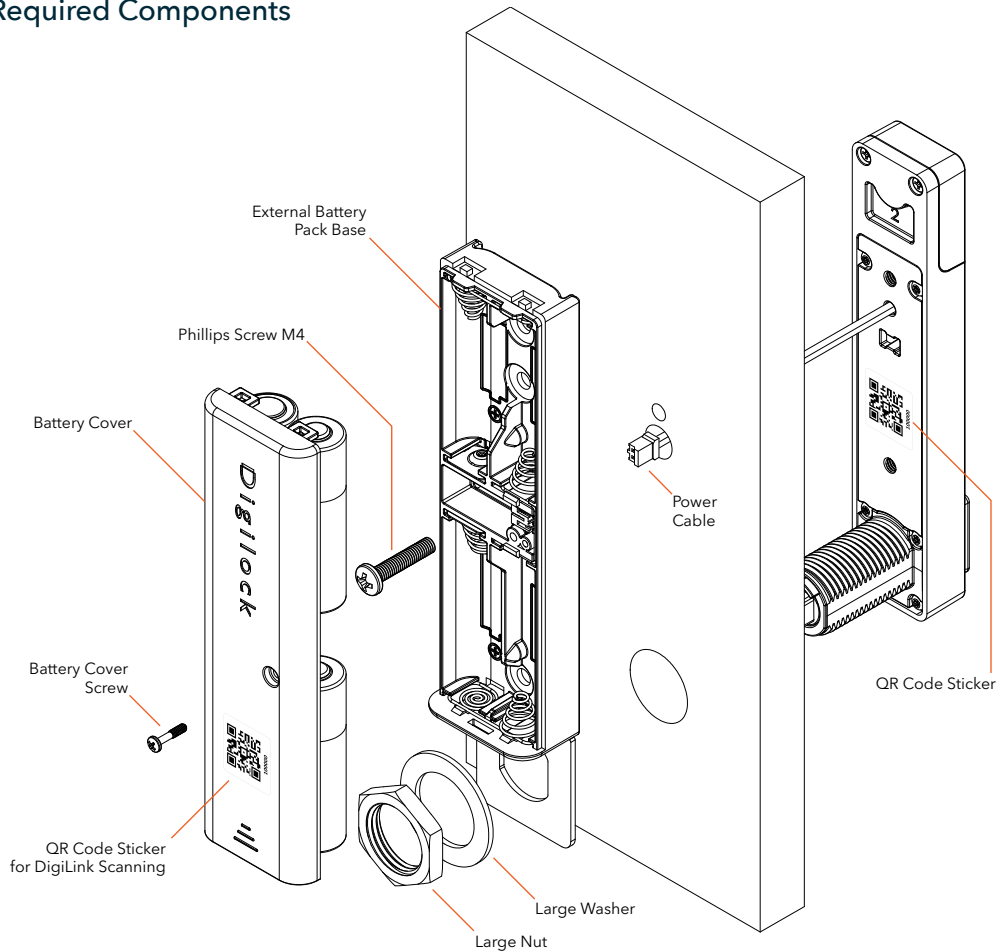

Power Cable Connection

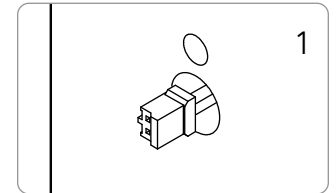

Pull the power cable through the door opening as shown.

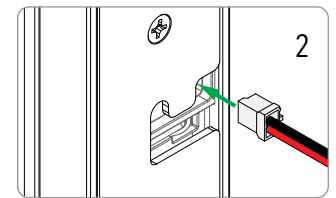

Insert through the rear opening of the battery base as shown.

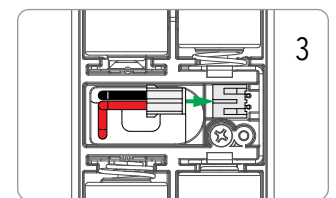

Connect the power cable as shown above.

Front View

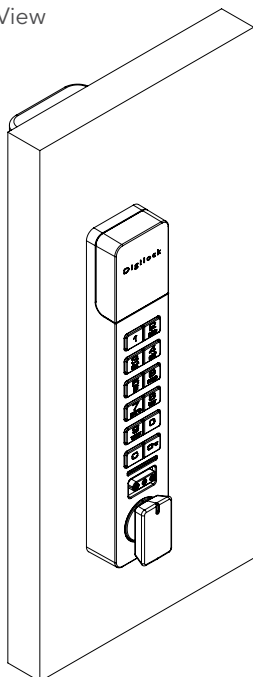

Side View

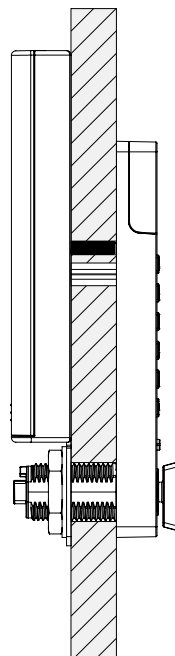

Rear View

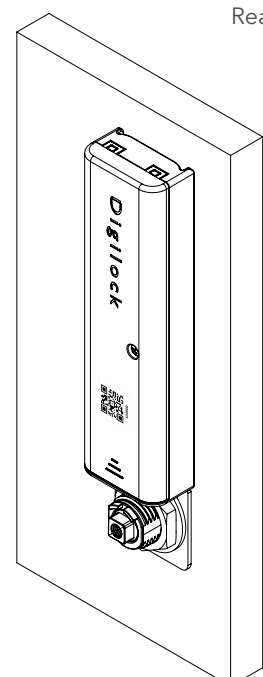

See Cam Guide for Cam Installation

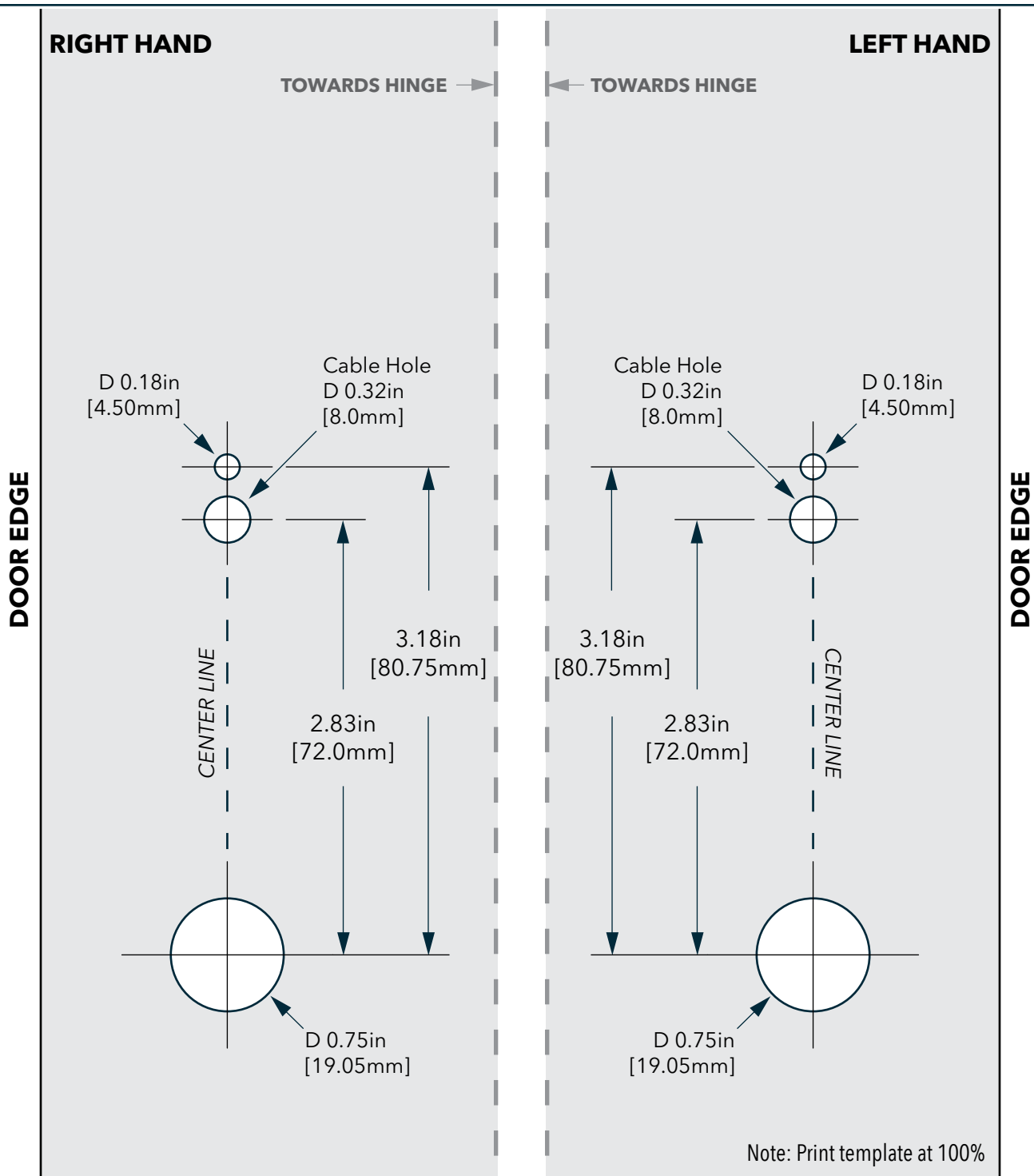
3-HOLE TEMPLATE**Recommended Tools for Installation (*Not Included)**

1 - Phillips Driver (#1)*

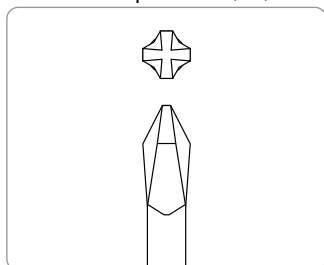

1 - Phillips Driver (#0)*

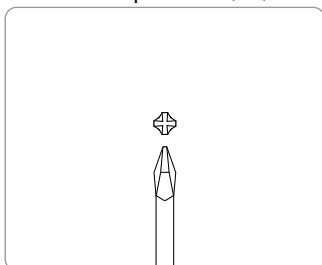

1 - 15/16" Deep Socket Driver*

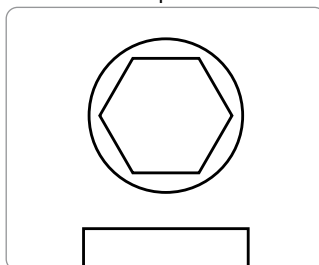

1 - Adjustable Wrench*

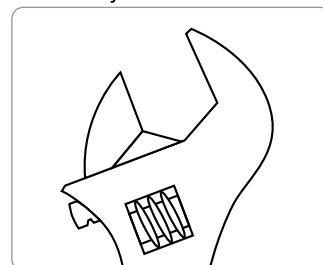

SURFACE KEYPAD INSTALLATION—CONCEALED PLATE

Surface Mount: For Door Thickness up to 25mm

Required Components

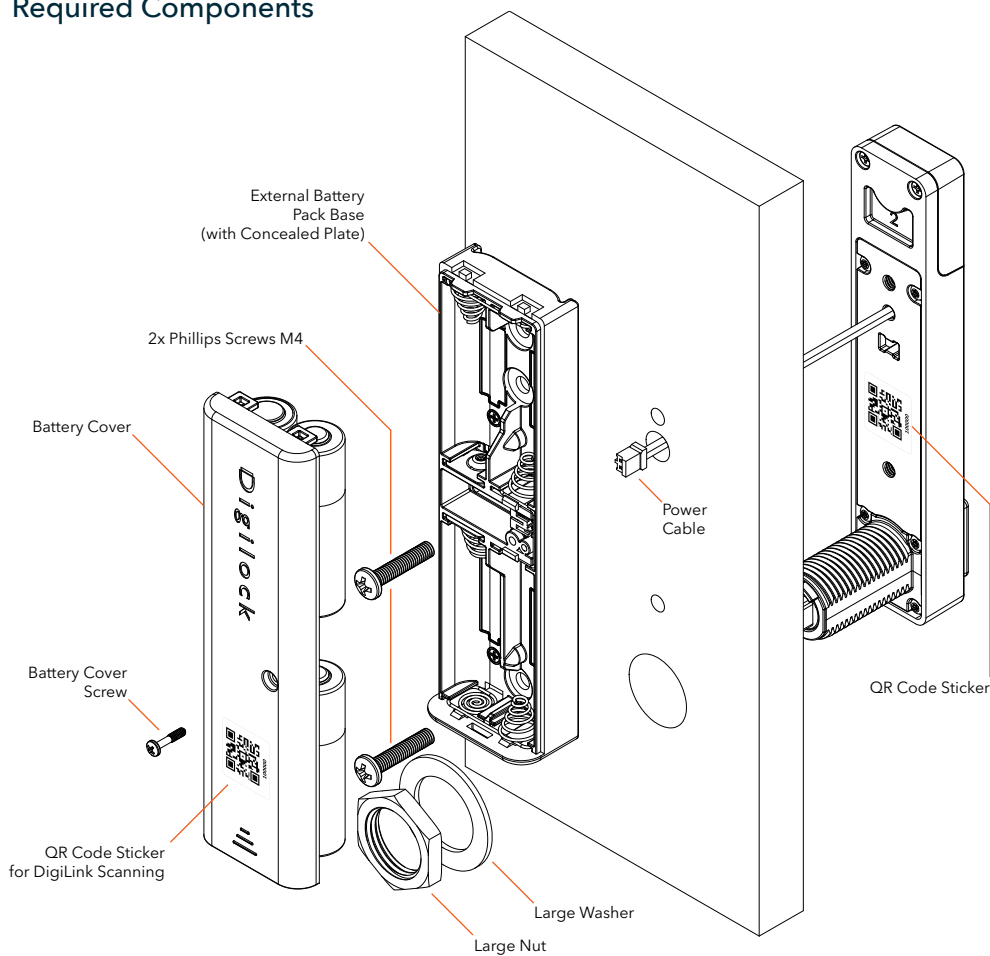

Power Cable Connection

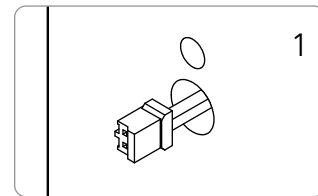

Pull the power cable through the door opening as shown.

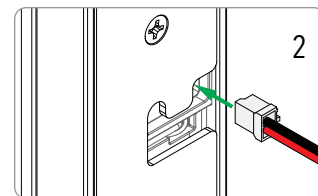

Insert through the rear opening of the battery base as shown.

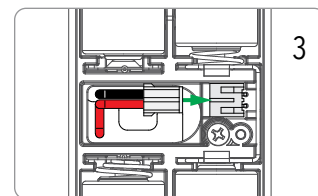

Connect the power cable as shown above.

Front View

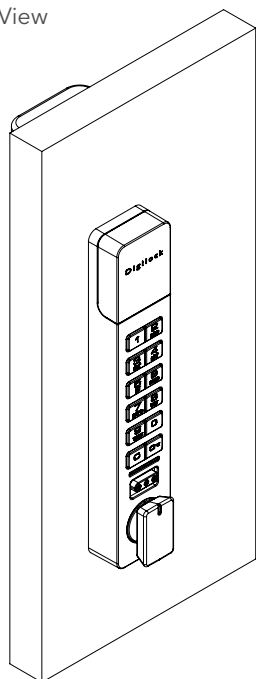

Side View

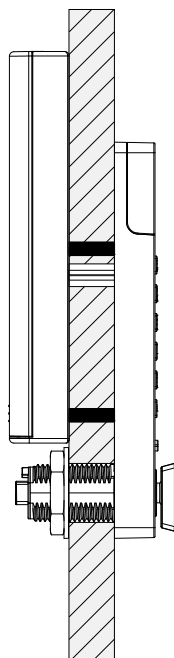

Rear View

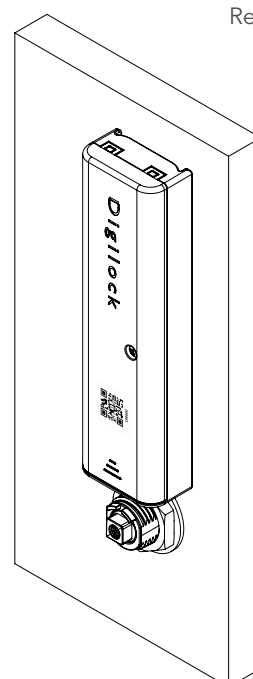

See Cam Guide for Cam Installation

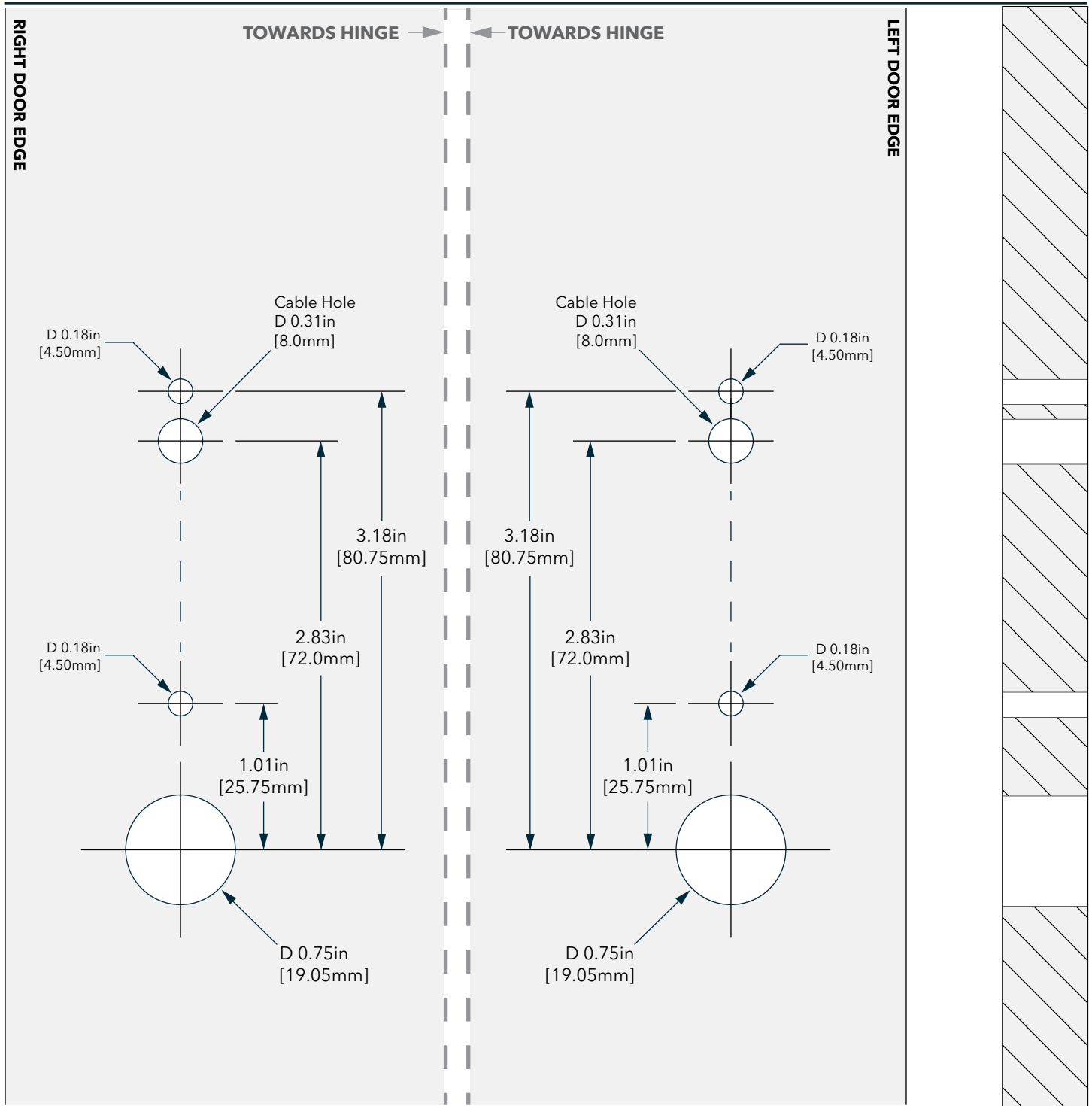
4-HOLE TEMPLATE—CONCEALED PLATE**Recommended Tools for Installation (*Not Included)****NOTE: PRINT TEMPLATE AT 100%**

1 - Phillips Driver (#1)*

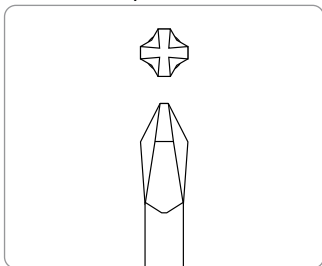

1 - Phillips Driver (#0)*

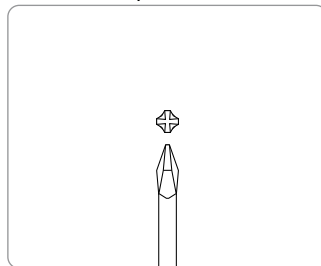

1 - 15/16" Deep Socket Driver*

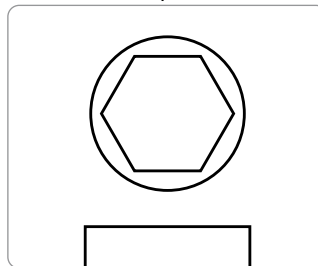

1 - Adjustable Wrench*

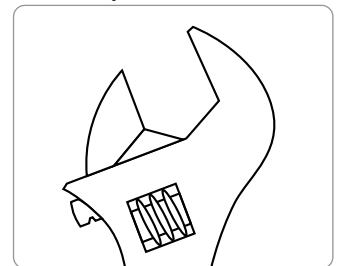

RECESS KEYPAD INSTALLATION

Recess Mount: For Door Thickness between 10mm-25mm

Required Components

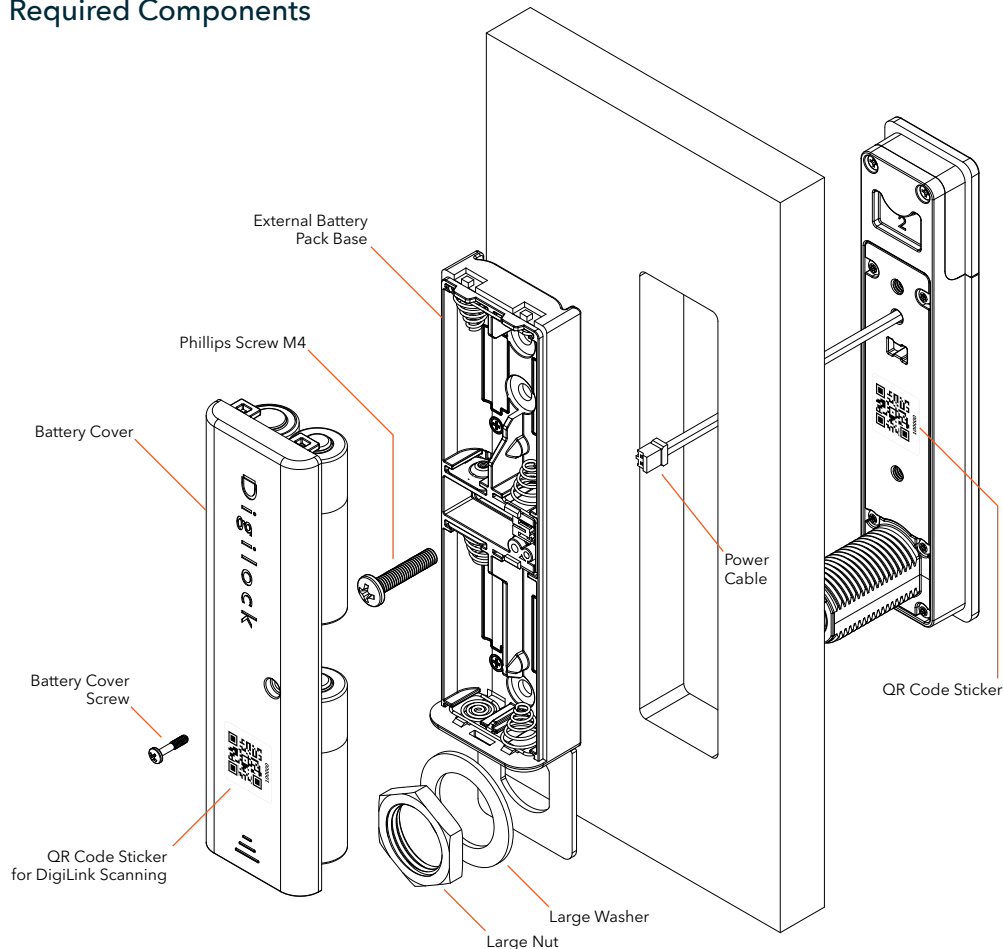

Power Cable Connection

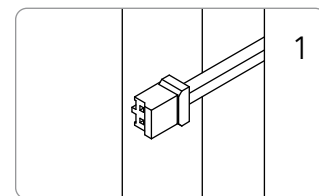

Pull the power cable through the door opening as shown.

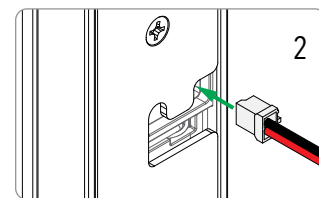

Insert through the rear opening of the battery base as shown.

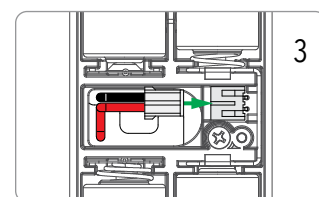

Connect the power cable as shown above.

Front View

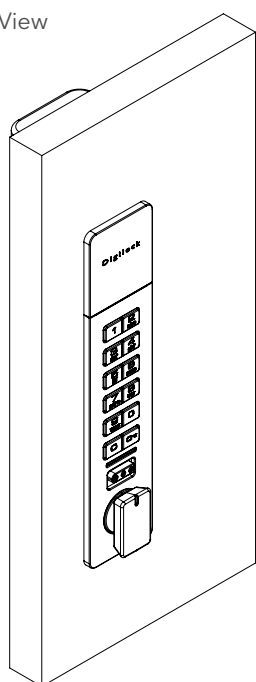

Side View

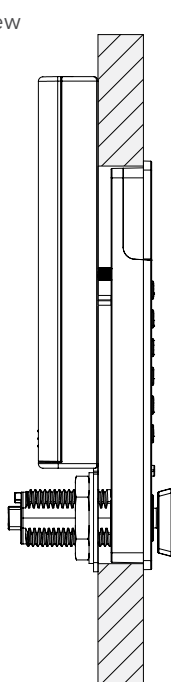

Rear View

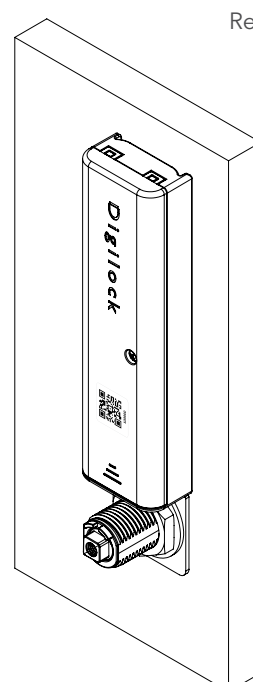

See Cam Guide for Cam Installation

RECESS MORTISE TEMPLATE

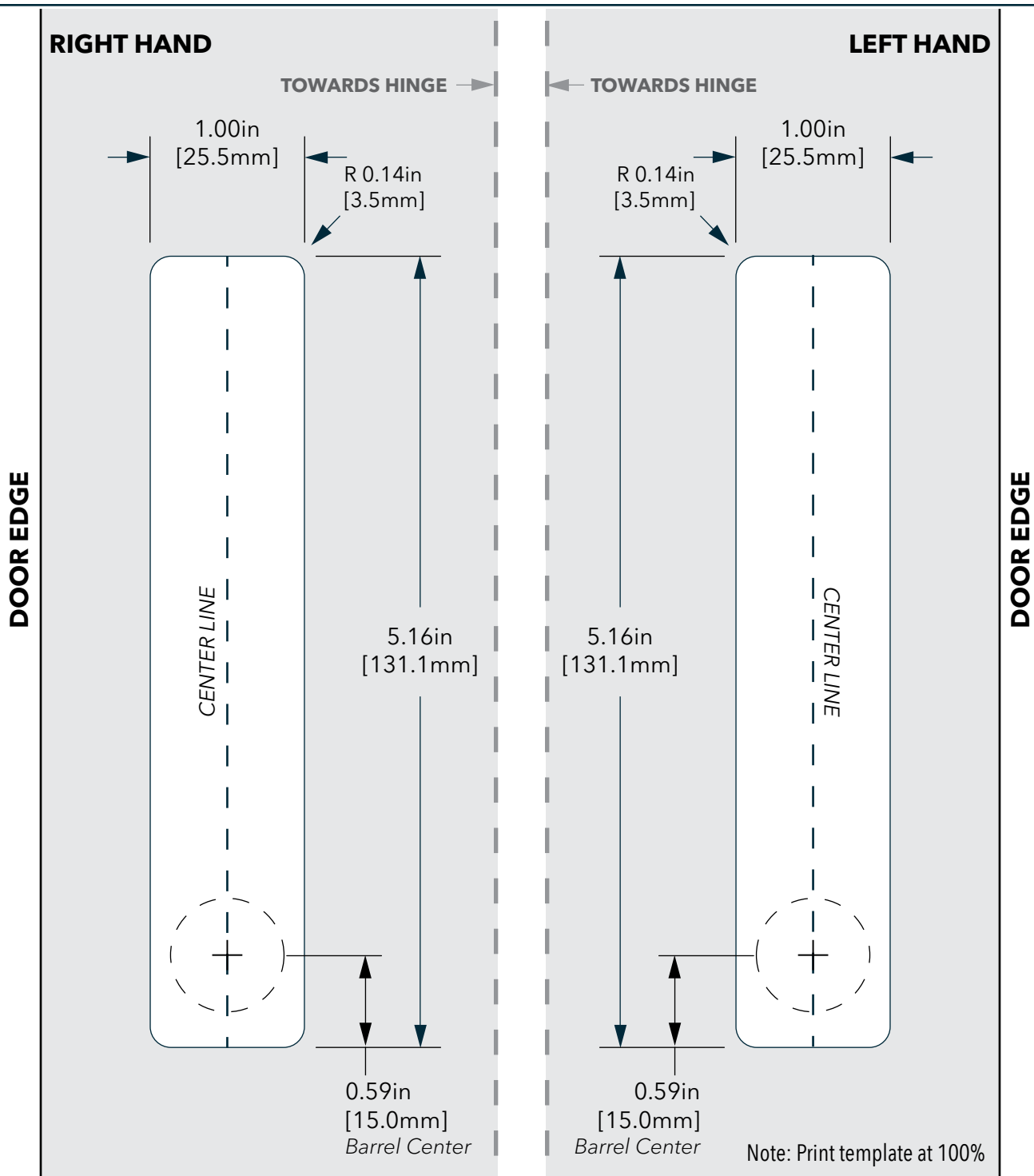

Recommended Tools for Installation (*Not Included)

1 - Phillips Driver (#1)*

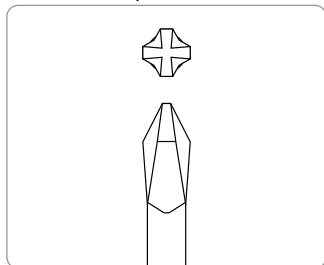

1 - Phillips Driver (#0)*

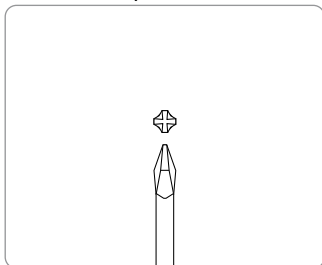

1 - 15/16" Deep Socket Driver*

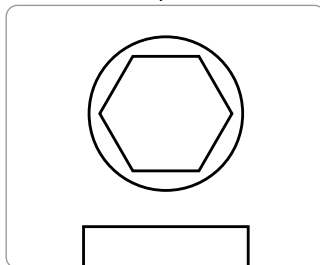

1 - Adjustable Wrench*

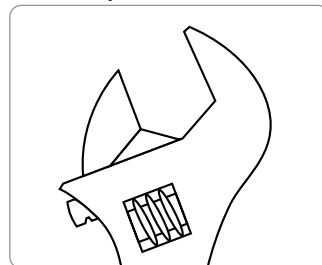

RECESS KEYPAD INSTALLATION—CONCEALED PLATE

Recess Mount: For Door Thickness between 10mm-25mm

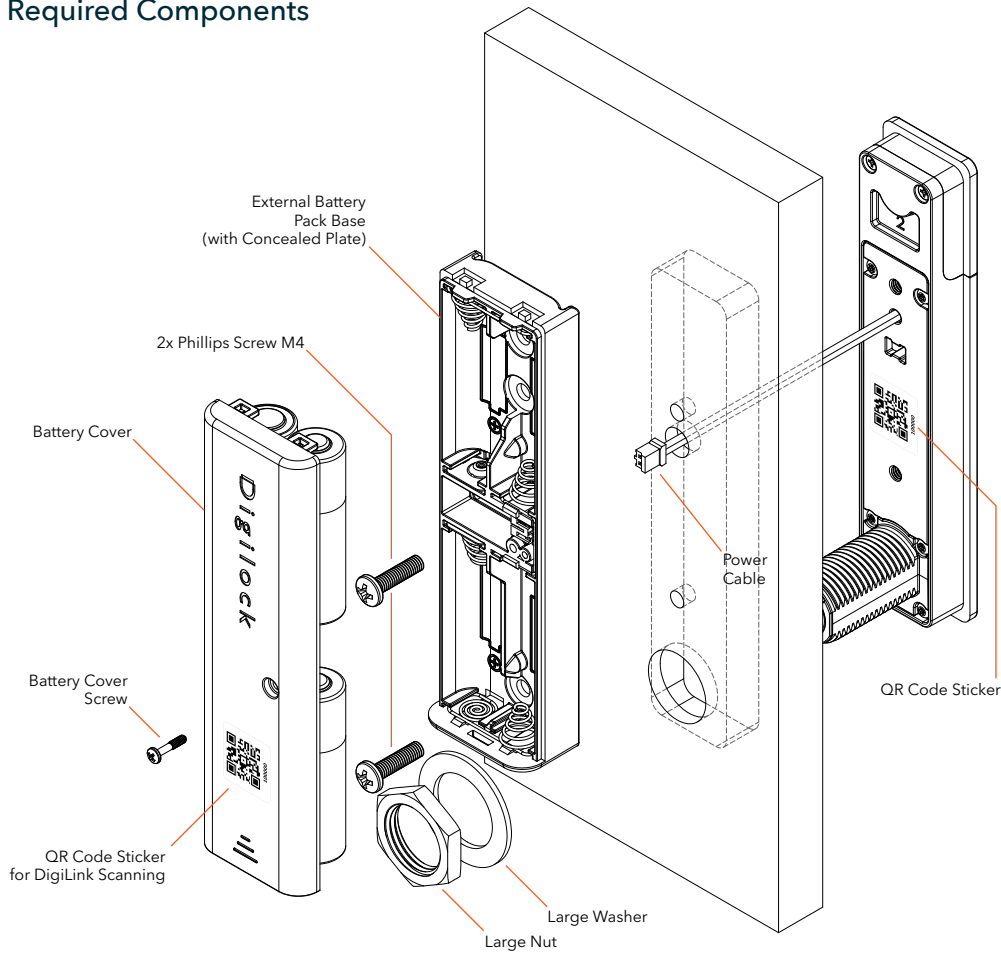
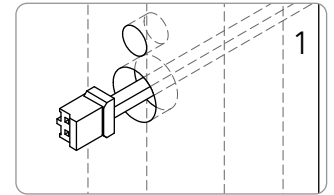
Required Components**Power Cable Connection**

Pull the power cable through the door opening as shown.

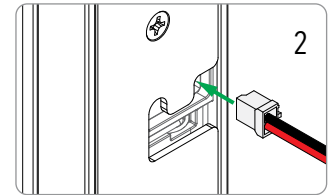

Insert through the rear opening of the battery base as shown..

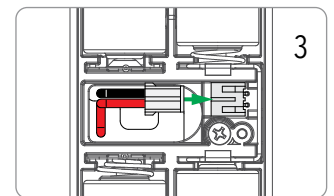

Connect the power cable as shown above.

Front View

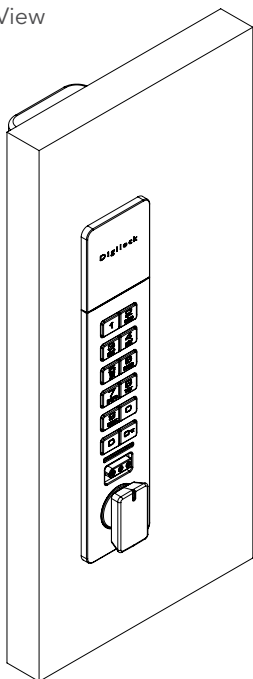

Side View

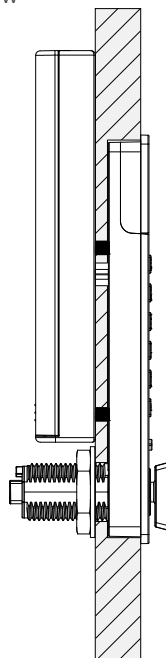

Rear View

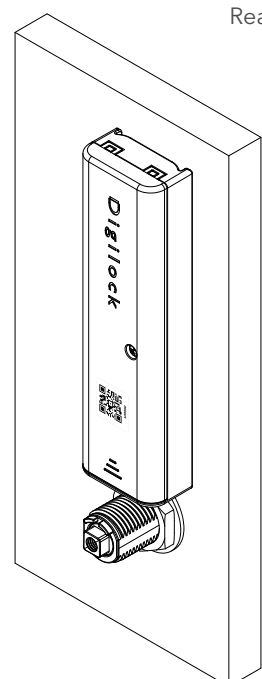
*See Cam Guide for Cam Installation*

RECESS MORTISE TEMPLATE—CONCEALED PLATE

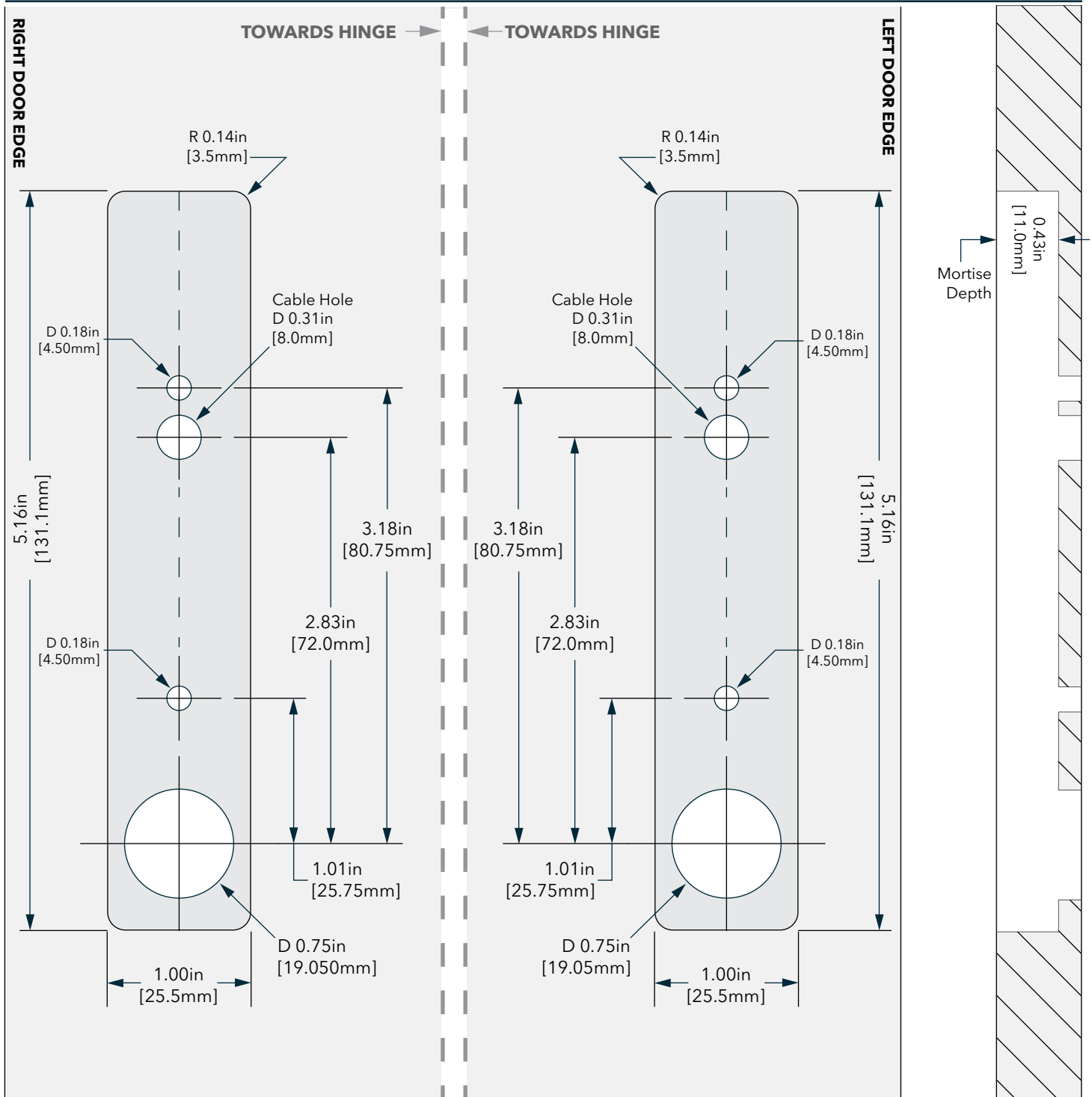
**NOTE: PRINT TEMPLATE AT 100%**

Recommended Tools for Installation (*Not Included)

1 - Phillips Driver (#1)*

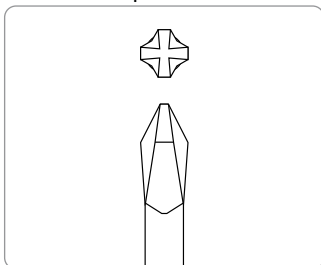

1 - Phillips Driver (#0)*

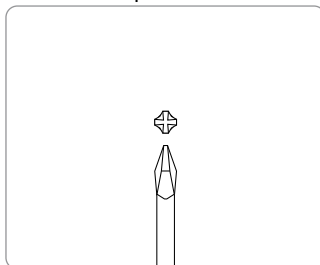

1 - 15/16" Deep Socket Driver*

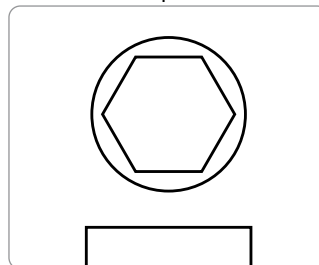

1 - Adjustable Wrench*

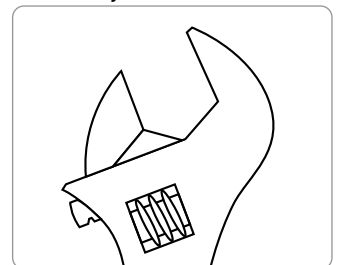

SURFACE RFID INSTALLATION

Surface Mount: For Door Thickness up to 25mm

Required Components

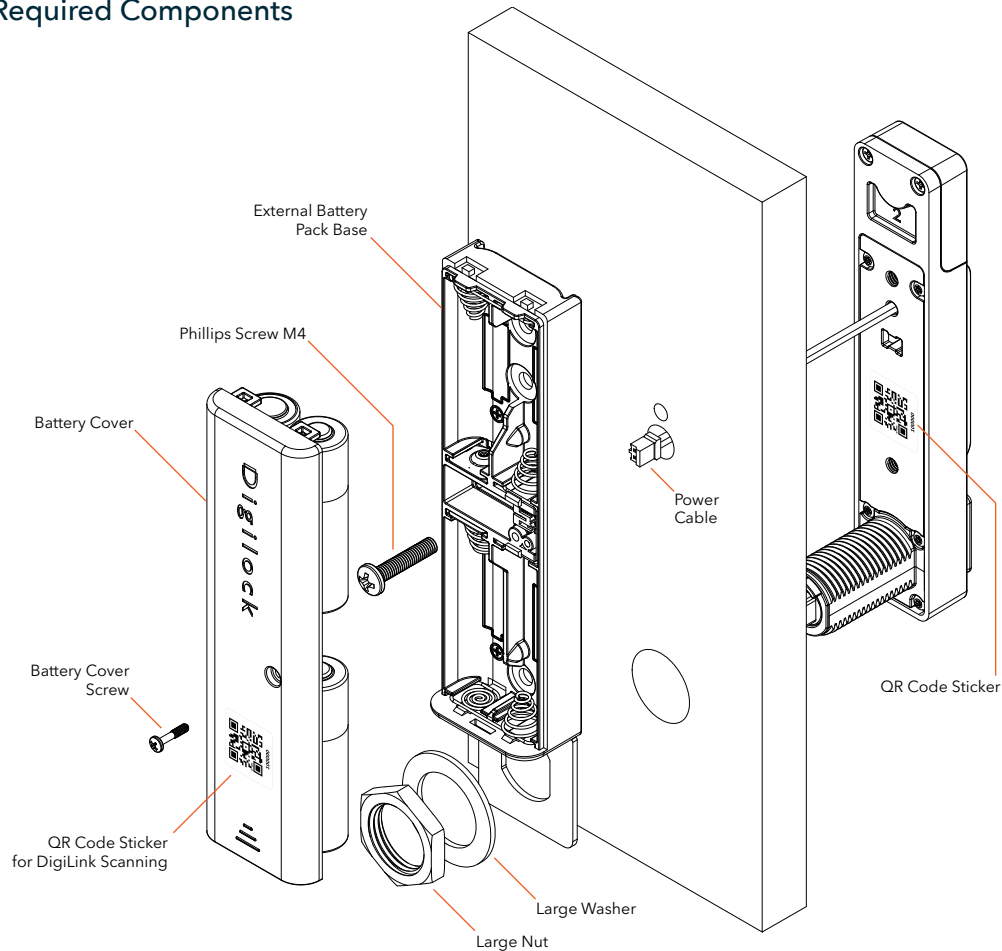

Power Cable Connection

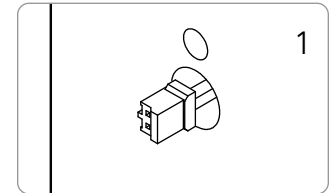

Pull the power cable through the door opening as shown.

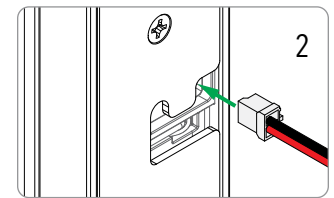

Insert through the rear opening of the battery base as shown.

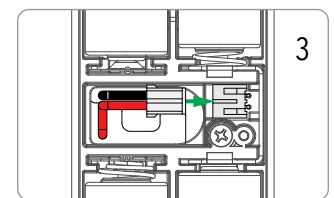

Connect the power cable as shown above.

Front View

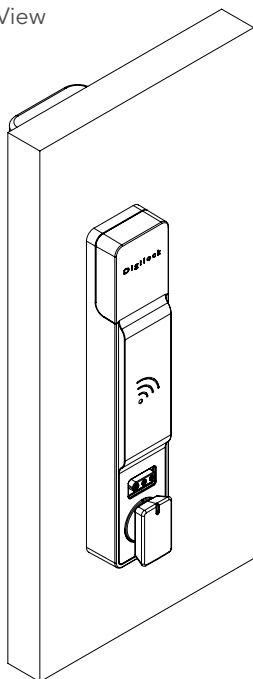

Side View

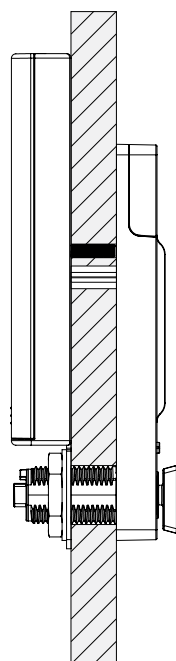

Rear View

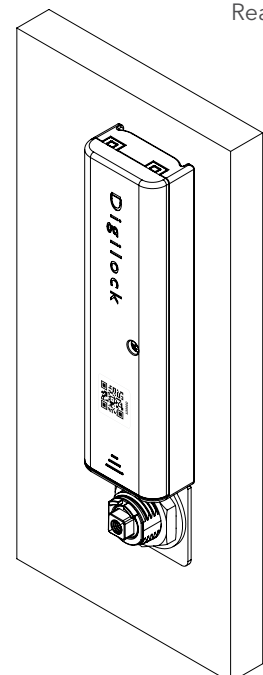

See Cam Guide for Cam Installation

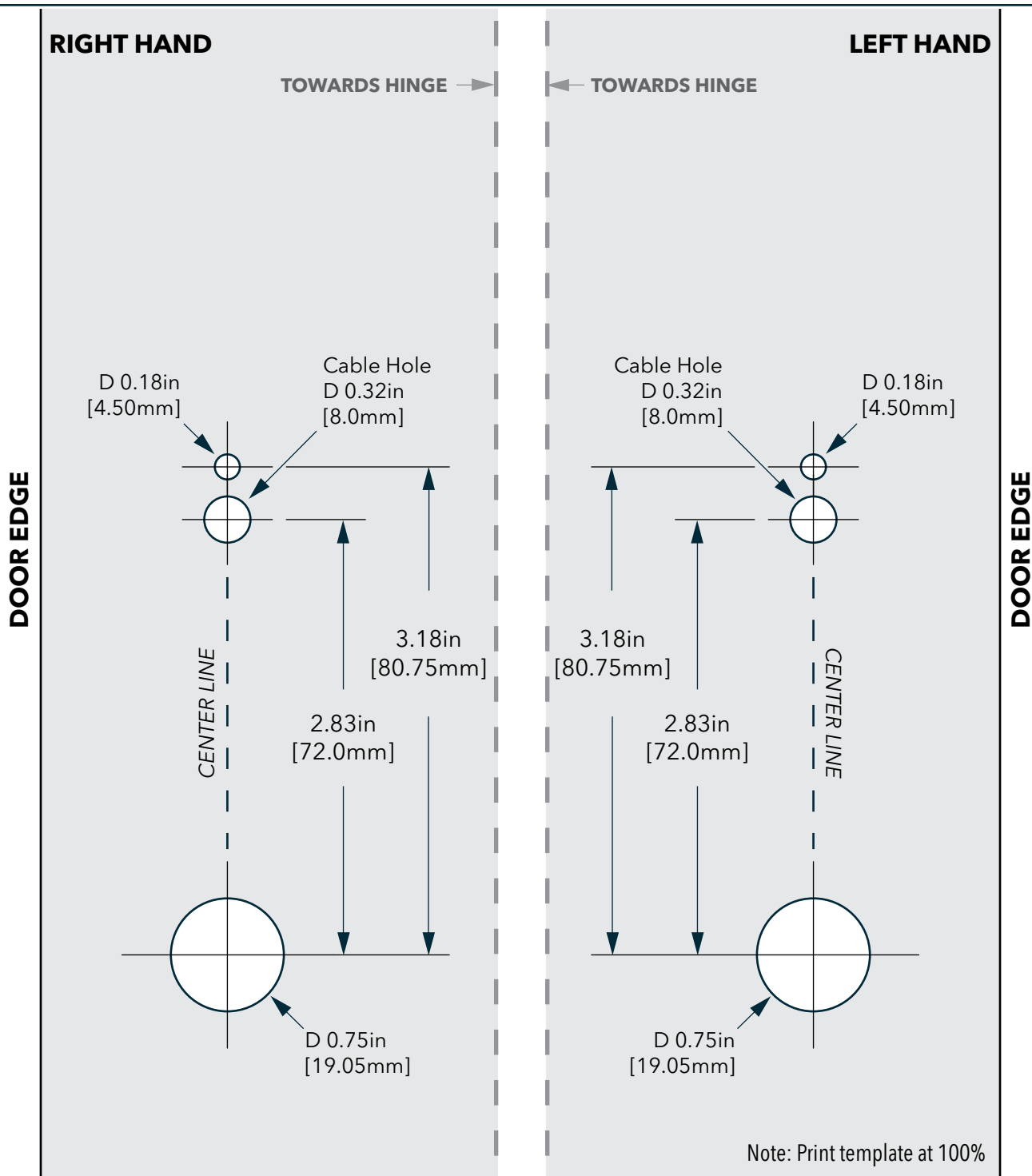
3-HOLE TEMPLATE**Recommended Tools for Installation (*Not Included)**

1 - Phillips Driver (#1)*

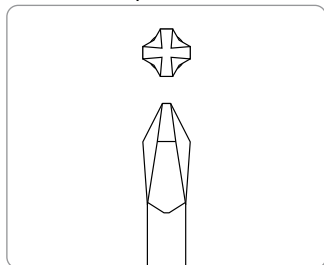

1 - Phillips Driver (#0)*

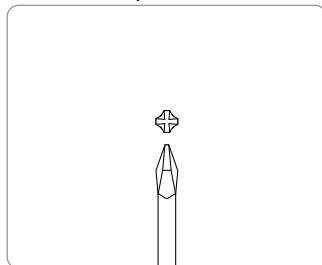

1 - 15/16" Deep Socket Driver*

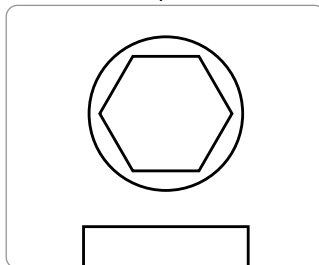

1 - Adjustable Wrench*

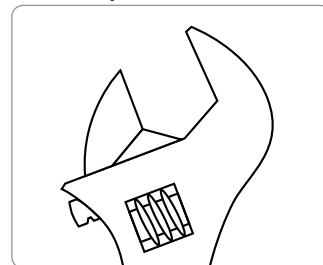

SURFACE RFID INSTALLATION—CONCEALED PLATE

Surface Mount: For Door Thickness up to 25mm

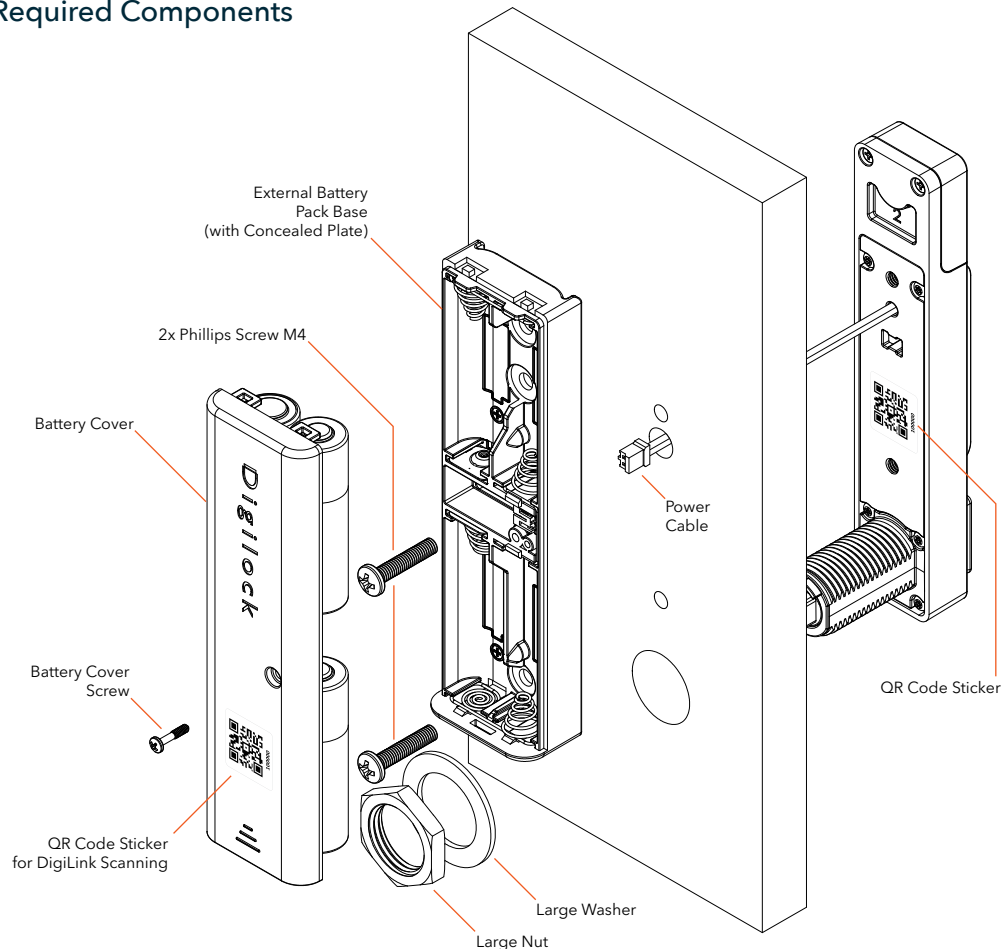
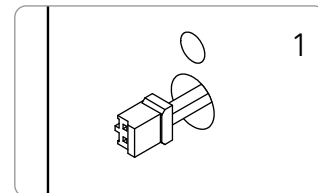
Required Components**Power Cable Connection**

Pull the power cable through the door opening as shown.

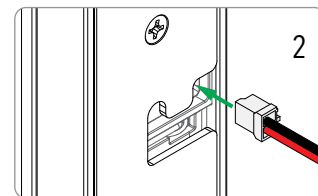

Insert through the rear opening of the battery base as shown.

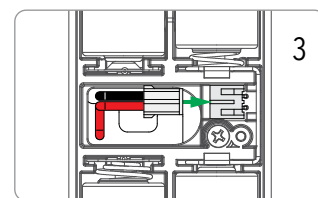

Connect the power cable as shown above.

Front View

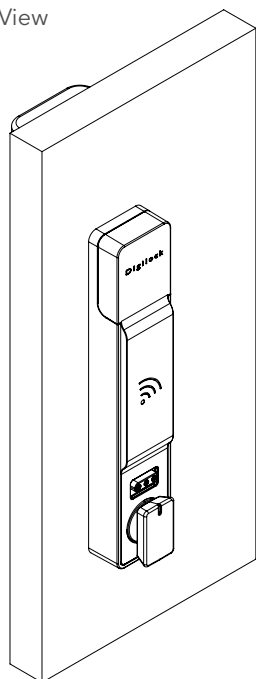

Side View

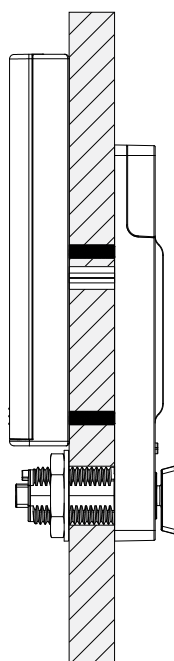

Rear View

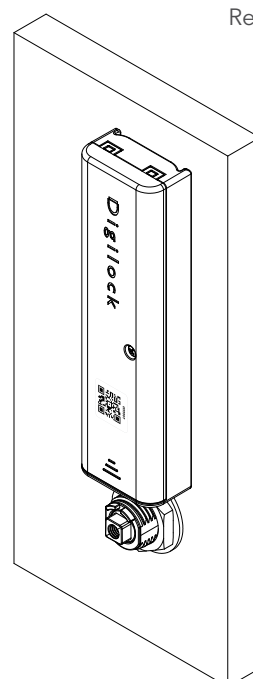

See Cam Guide for Cam Installation

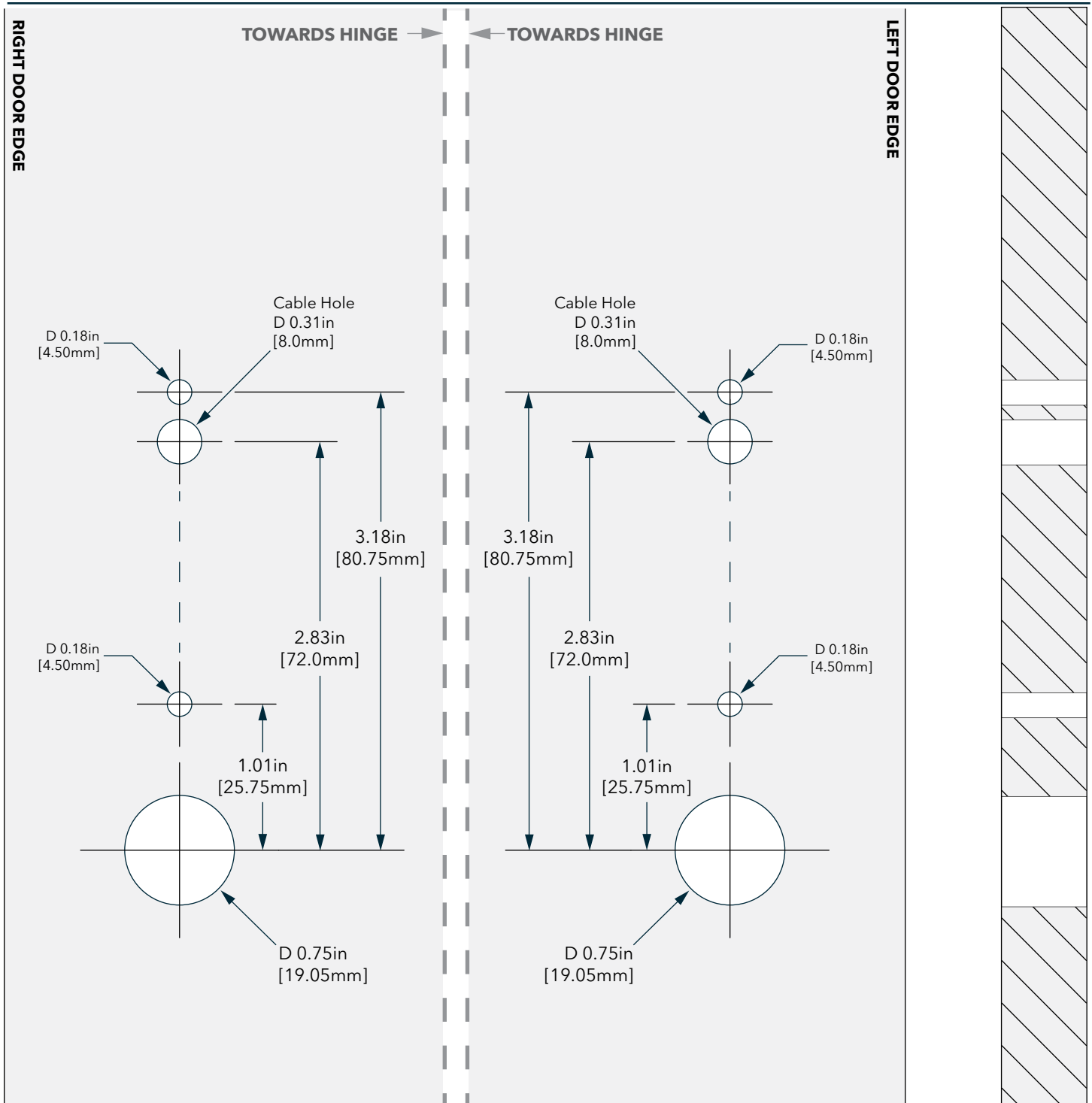
4-HOLE TEMPLATE—CONCEALED PLATE**Recommended Tools for Installation (*Not Included)****NOTE: PRINT TEMPLATE AT 100%**

1 - Phillips Driver (#1)*

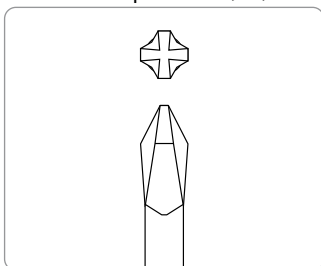

1 - Phillips Driver (#0)*

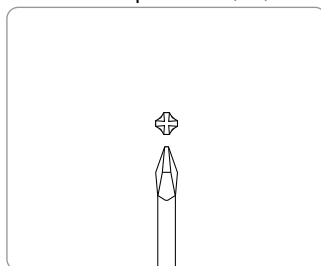

1 - 15/16" Deep Socket Driver*

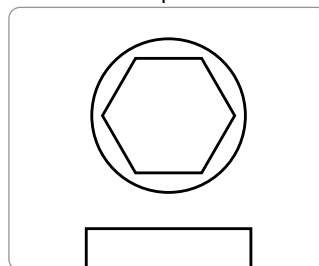

1 - Adjustable Wrench*

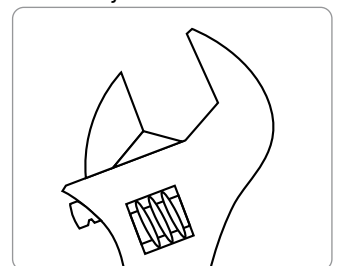

RECESS RFID INSTALLATION

Recess Mount: For Door Thickness between 10mm-25mm

Required Components

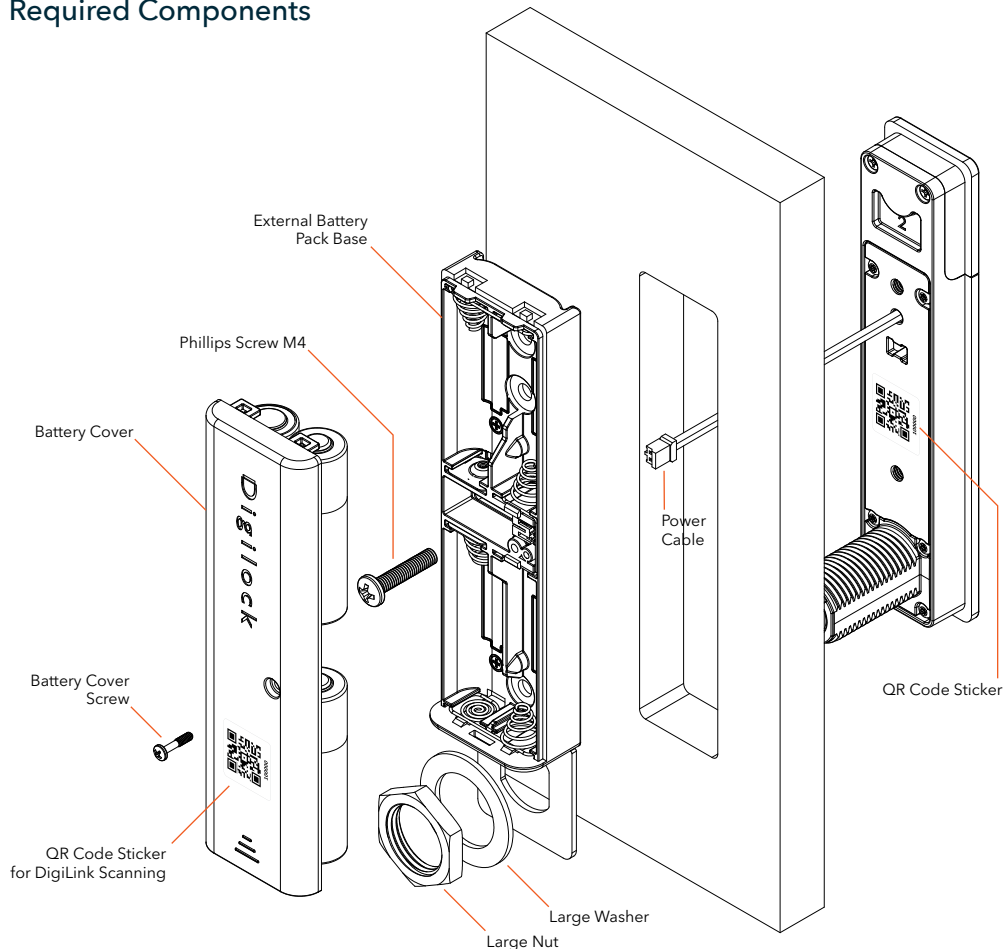

Power Cable Connection

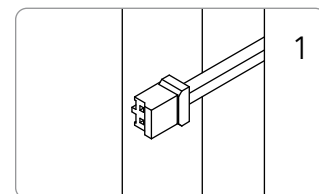

Pull the power cable through the door opening as shown.

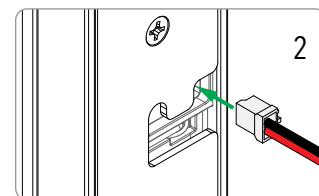

Insert through the rear opening of the battery base as shown.

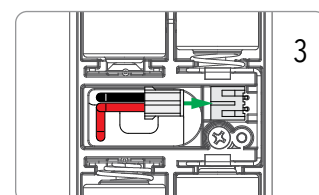

Connect the power cable as shown above.

Front View

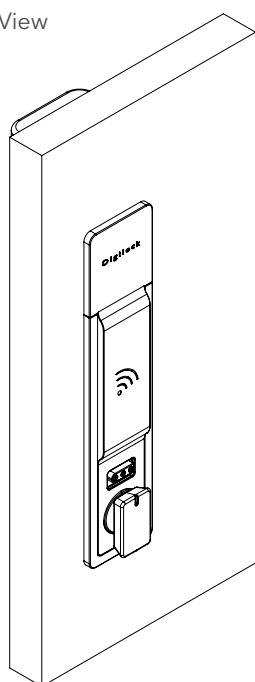

Side View

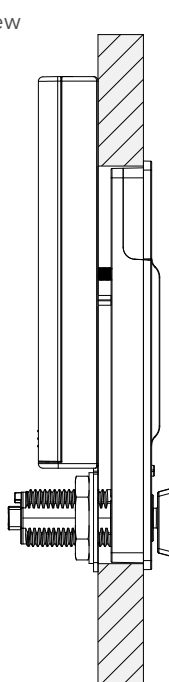

Rear View

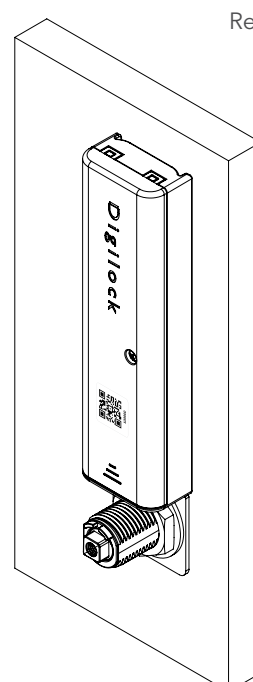

See Cam Guide for Cam Installation

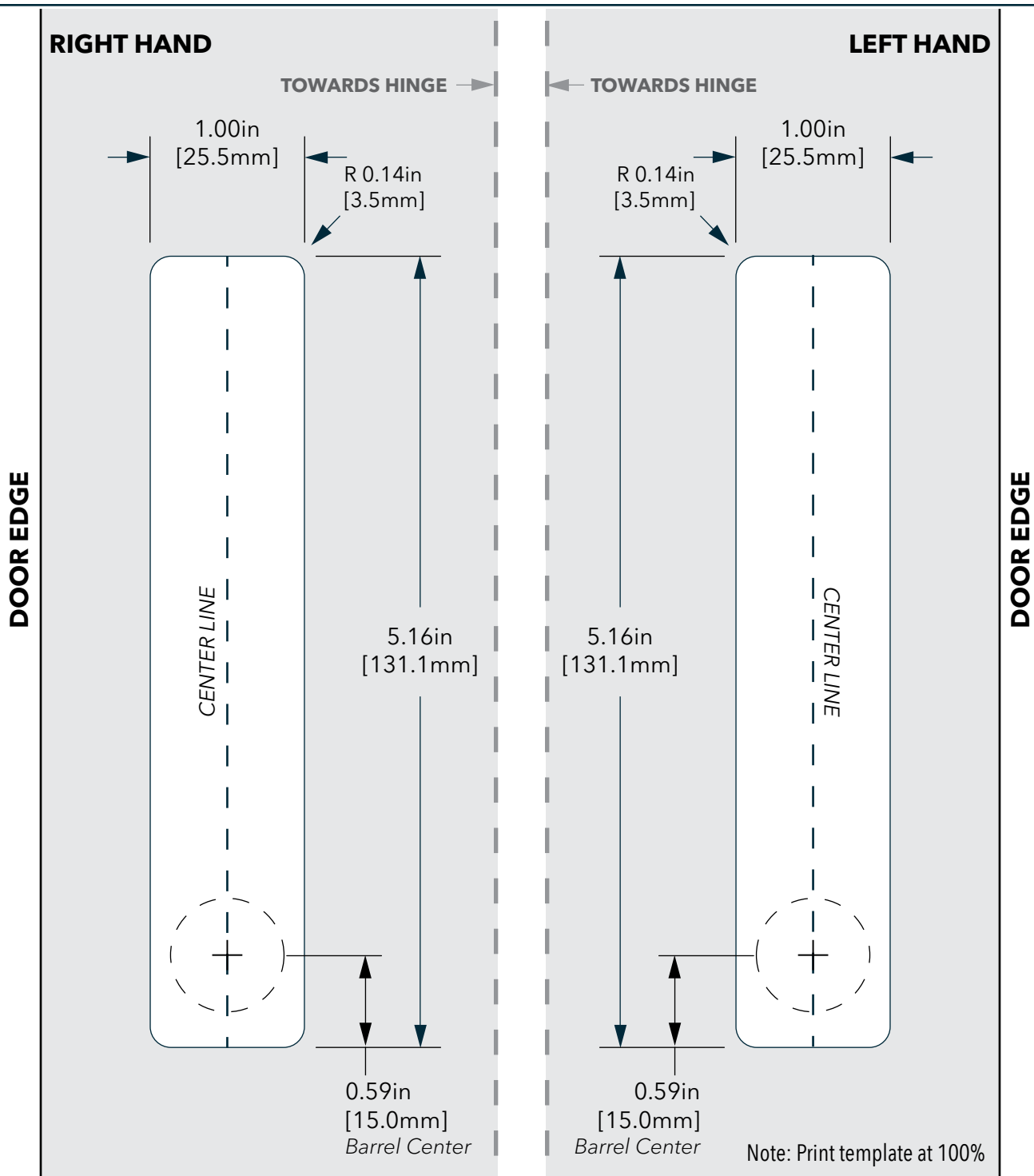
MORTISE TEMPLATE**Recommended Tools for Installation (*Not Included)**

1 - Phillips Driver (#1)*

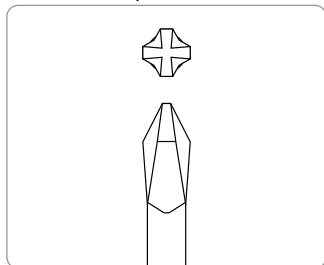

1 - Phillips Driver (#0)*

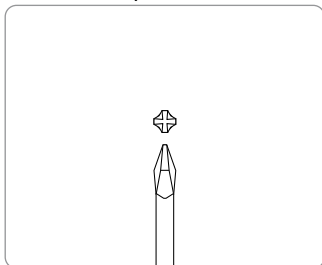

1 - 15/16" Deep Socket Driver*

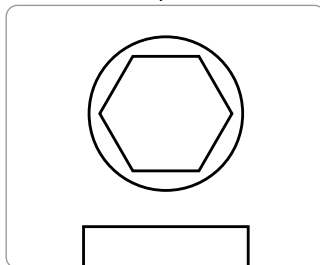

1 - Adjustable Wrench*

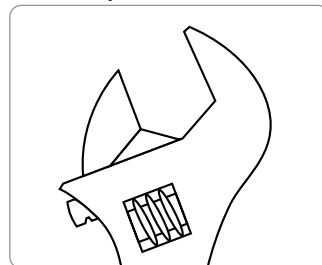

RECESS RFID INSTALLATION—CONCEALED PLATE

Recess Mount: For Door Thickness between 10mm-25mm

Required Components

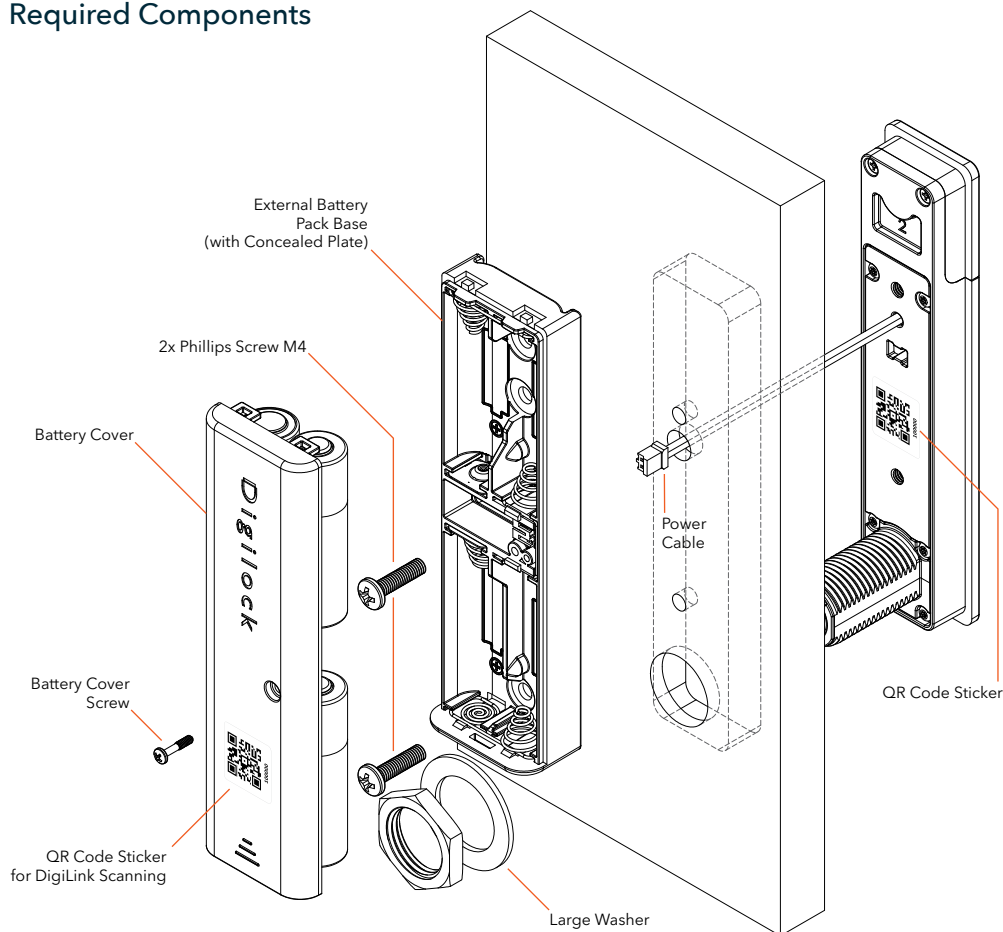

Power Cable Connection

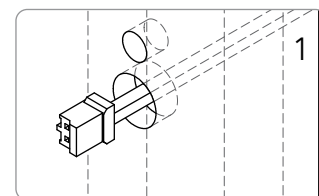

Pull the power cable through the door opening as shown.

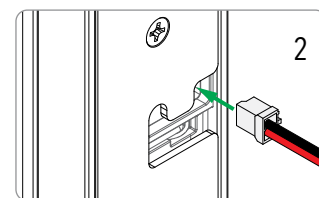

Insert through the rear opening of the battery base as shown.

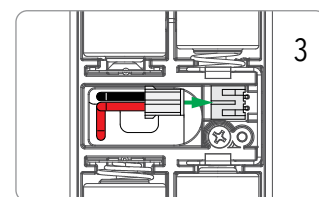

Connect the power cable as shown above.

Front View

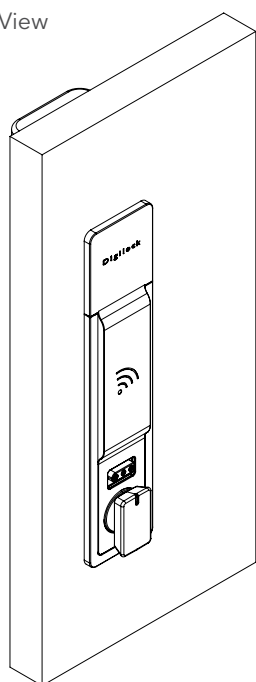

Side View

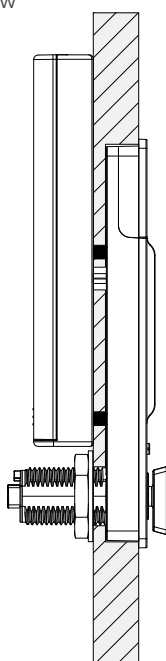

Rear View

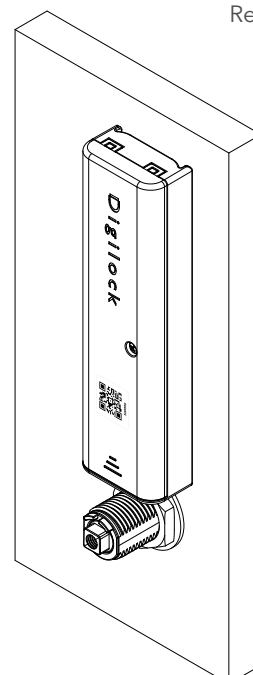

See Cam Guide for Cam Installation

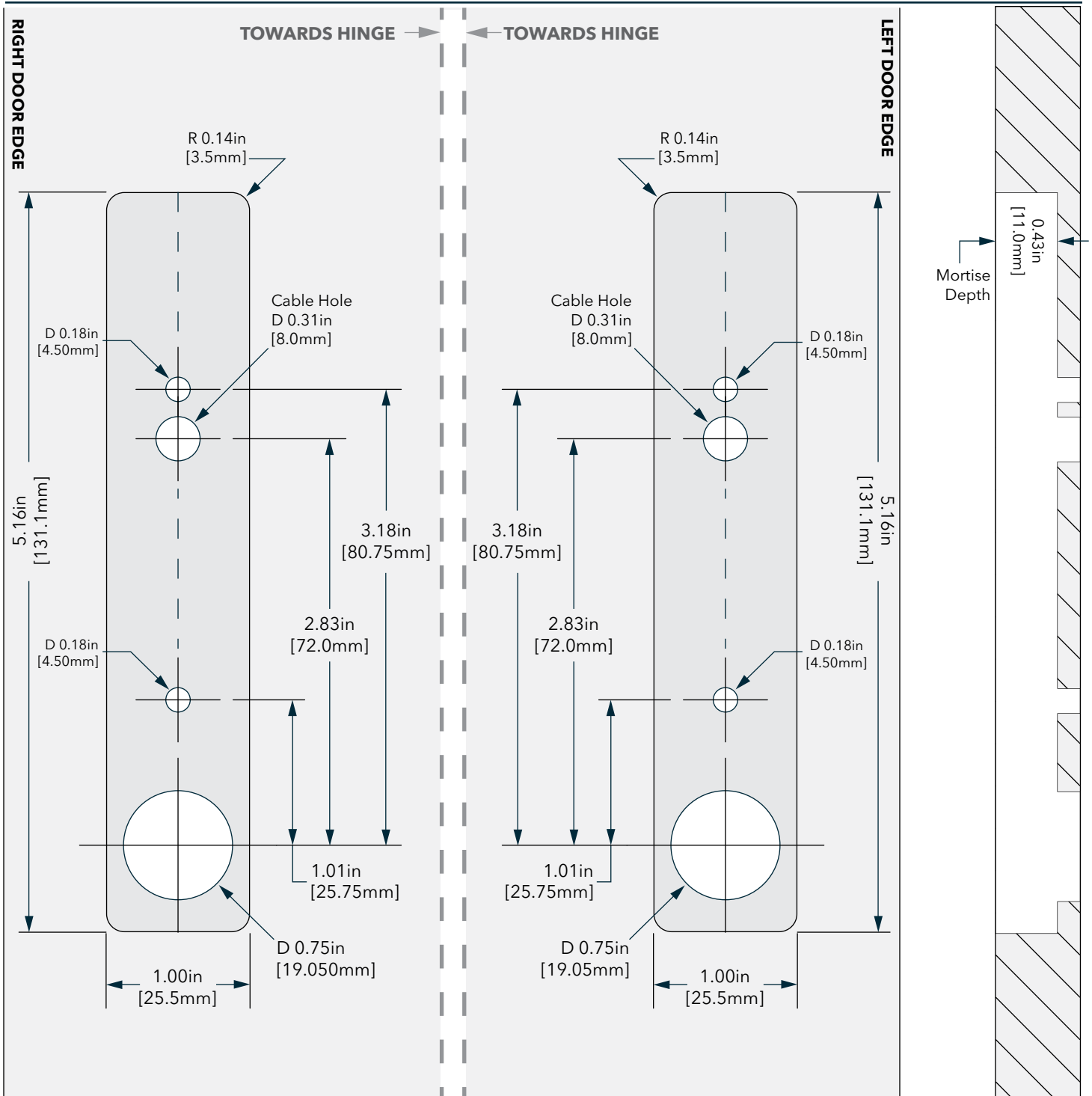
MORTISE TEMPLATE—CONCEALED PLATE**NOTE: PRINT TEMPLATE AT 100%****Recommended Tools for Installation (*Not Included)**

1 - Phillips Driver (#1)*

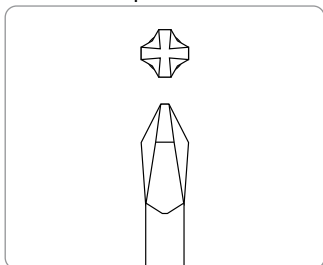

1 - Phillips Driver (#0)*

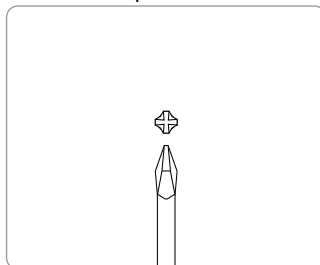

1 - 15/16" Deep Socket Driver*

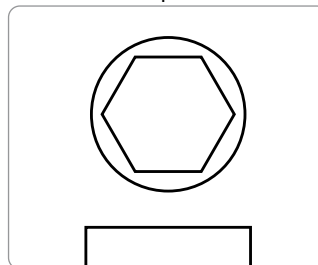

1 - Adjustable Wrench*

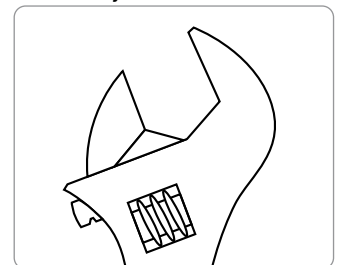

SURFACE KEYPAD INSTALLATION

Surface Mount: For Door Thickness less than 10mm

Required Components

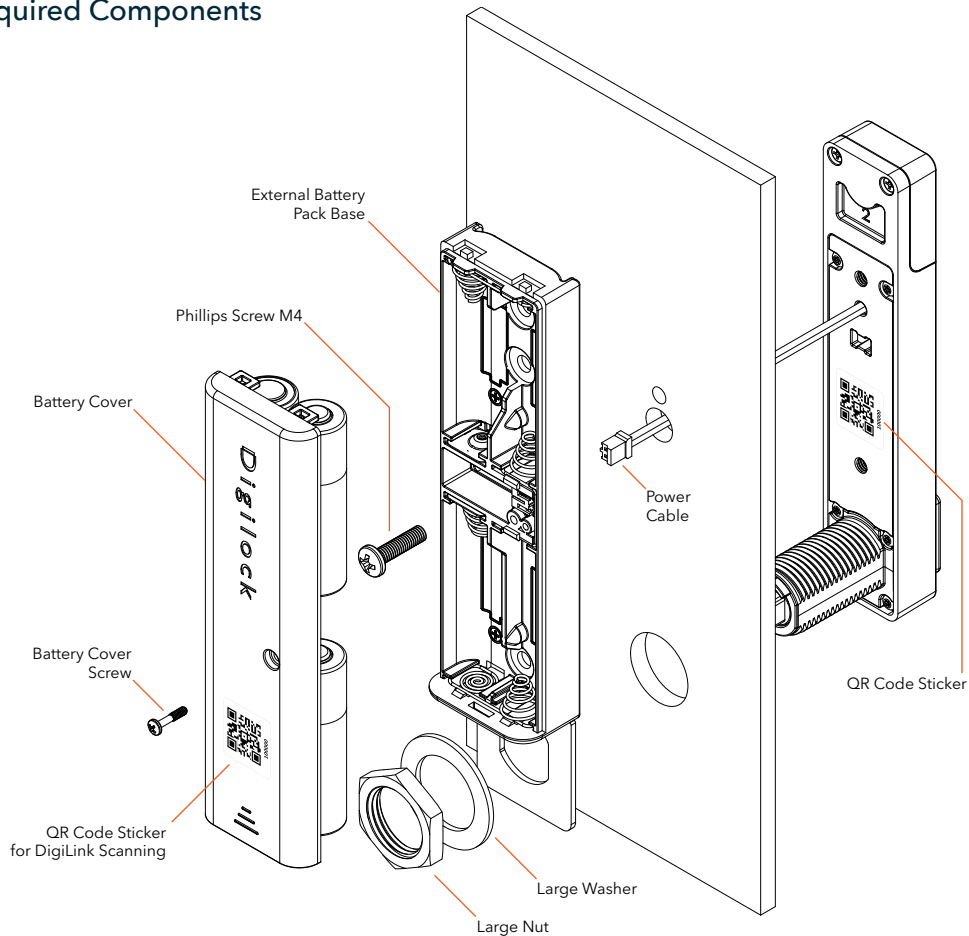

Power Cable Connection

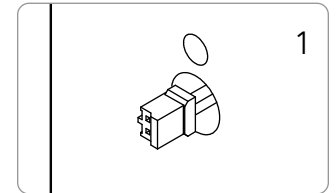

Pull the power cable through the door opening as shown.

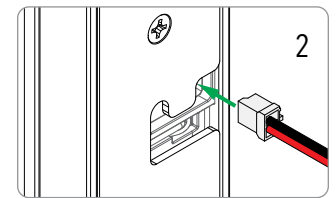

Insert through the rear opening of the battery base as shown.

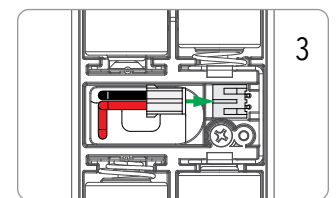

Connect the power cable as shown above.

Front View

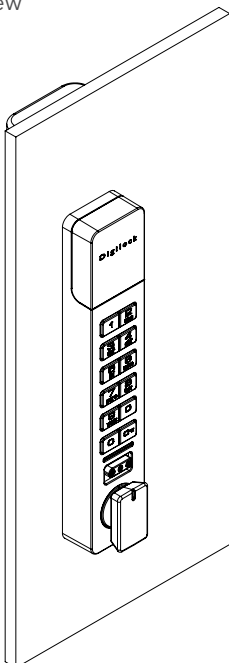

Side View

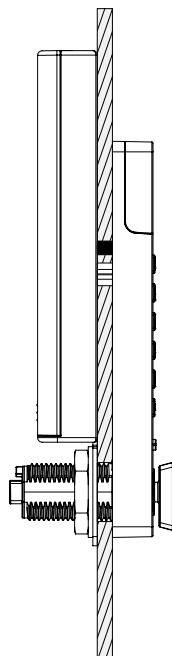

Rear View

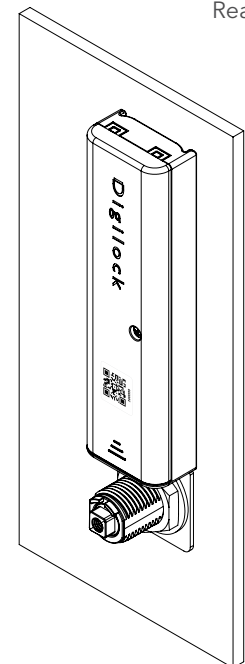

See Cam Guide for Cam Installation

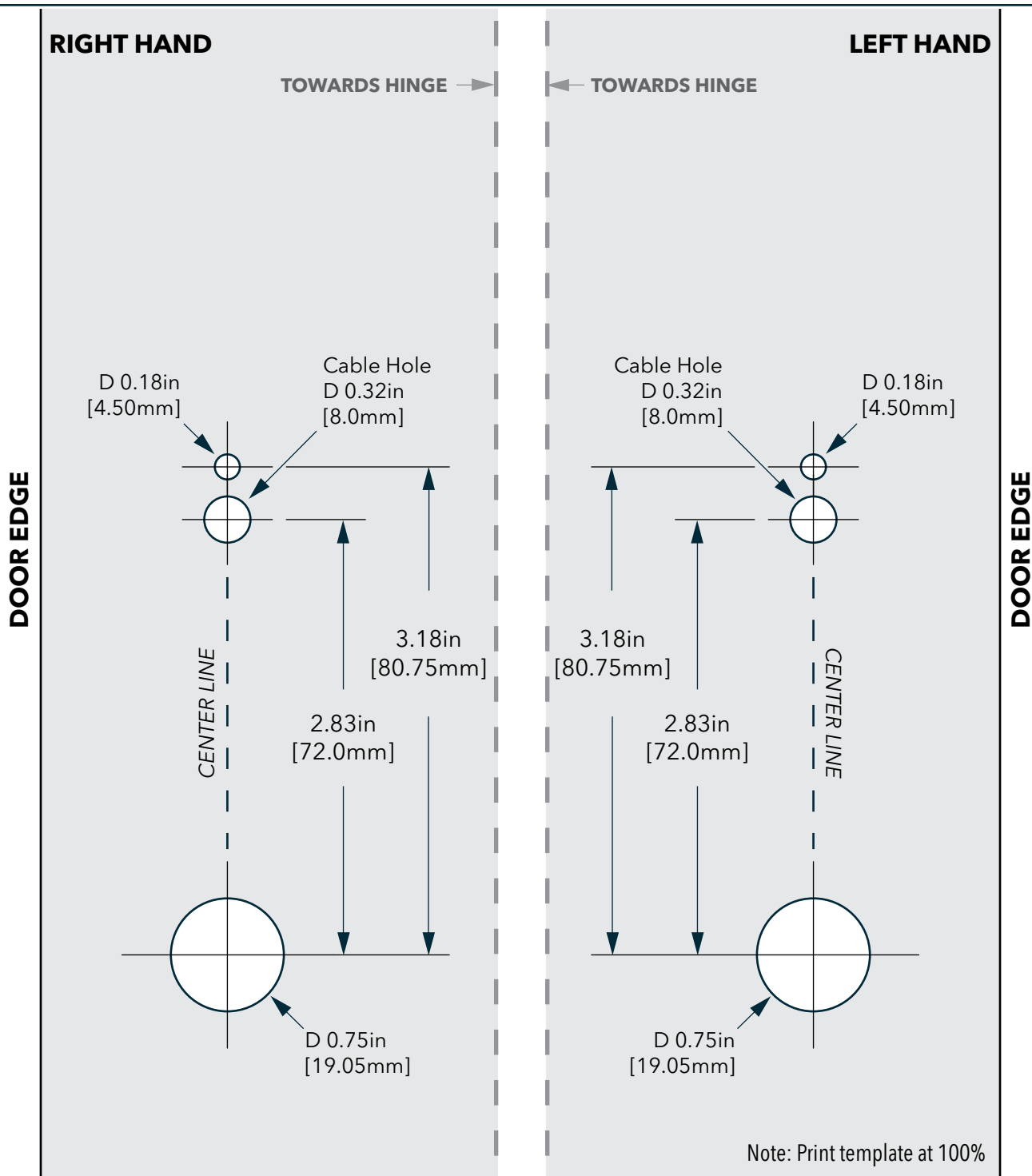
3-HOLE TEMPLATE**Recommended Tools for Installation (*Not Included)**

1 - Phillips Driver (#1)*

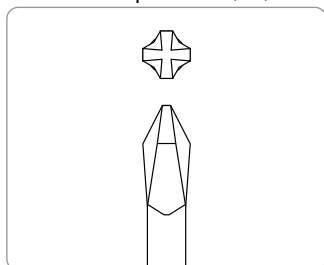

1 - Phillips Driver (#0)*

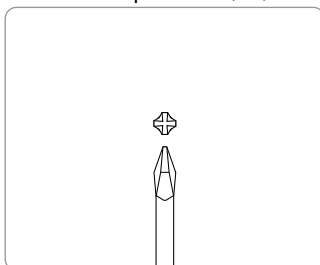

1 - 15/16" Deep Socket Driver*

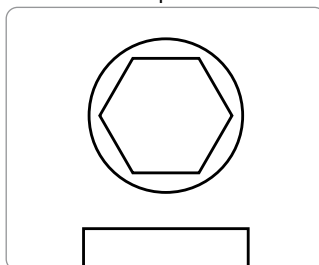

1 - Adjustable Wrench*

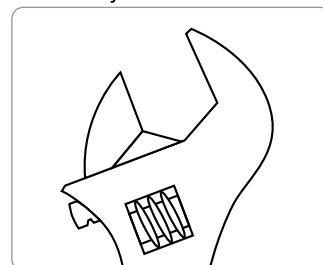

SURFACE KEYPAD INSTALLATION—CONCEALED PLATE

Surface Mount: For Door Thickness less than 10mm

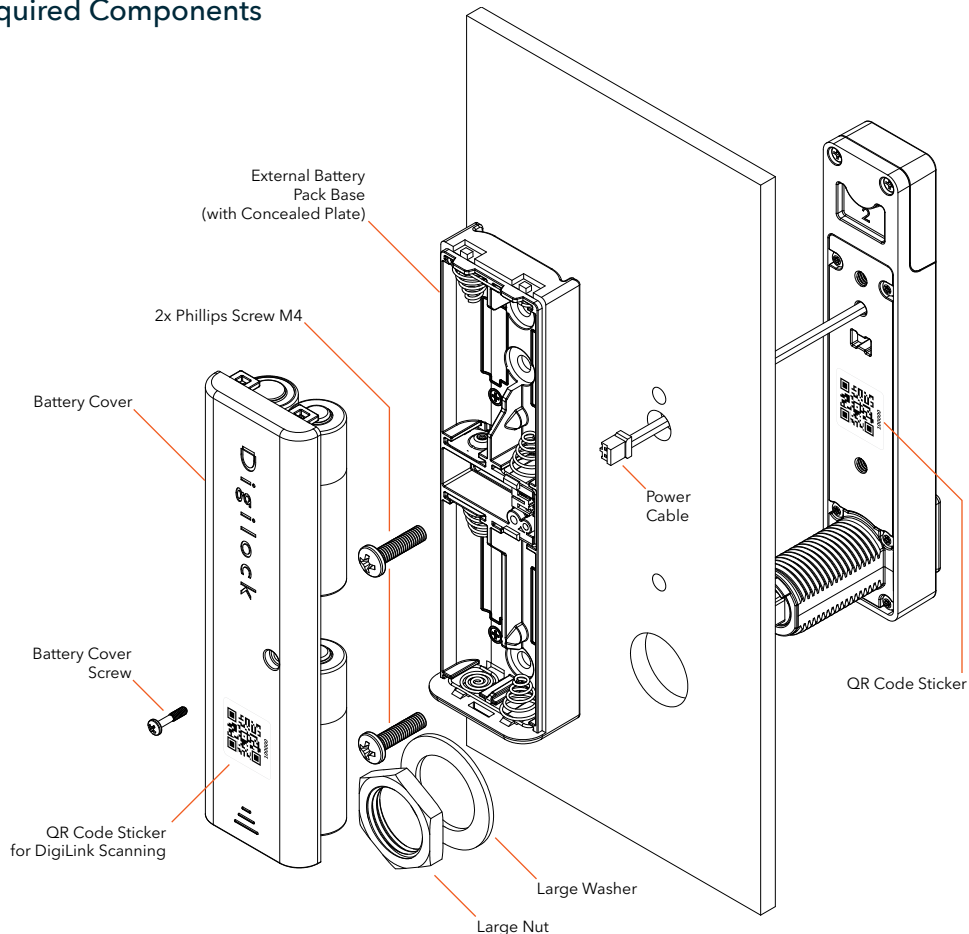
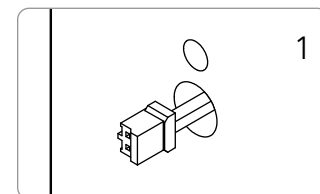
Required Components**Power Cable Connection**

Pull the power cable through the door opening as shown.

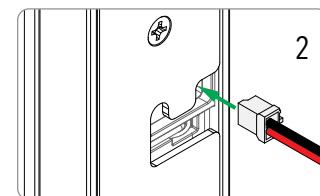

Insert through the rear opening of the battery base as shown..

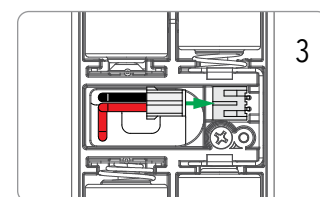

Connect the power cable as shown above.

Front View

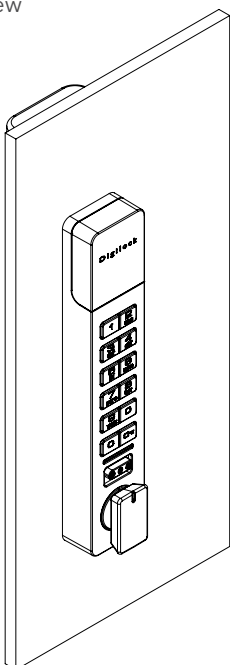

Side View

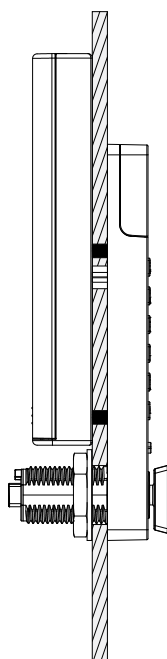

Rear View

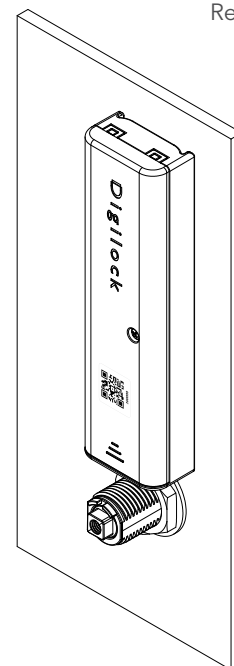
*See Cam Guide for Cam Installation*

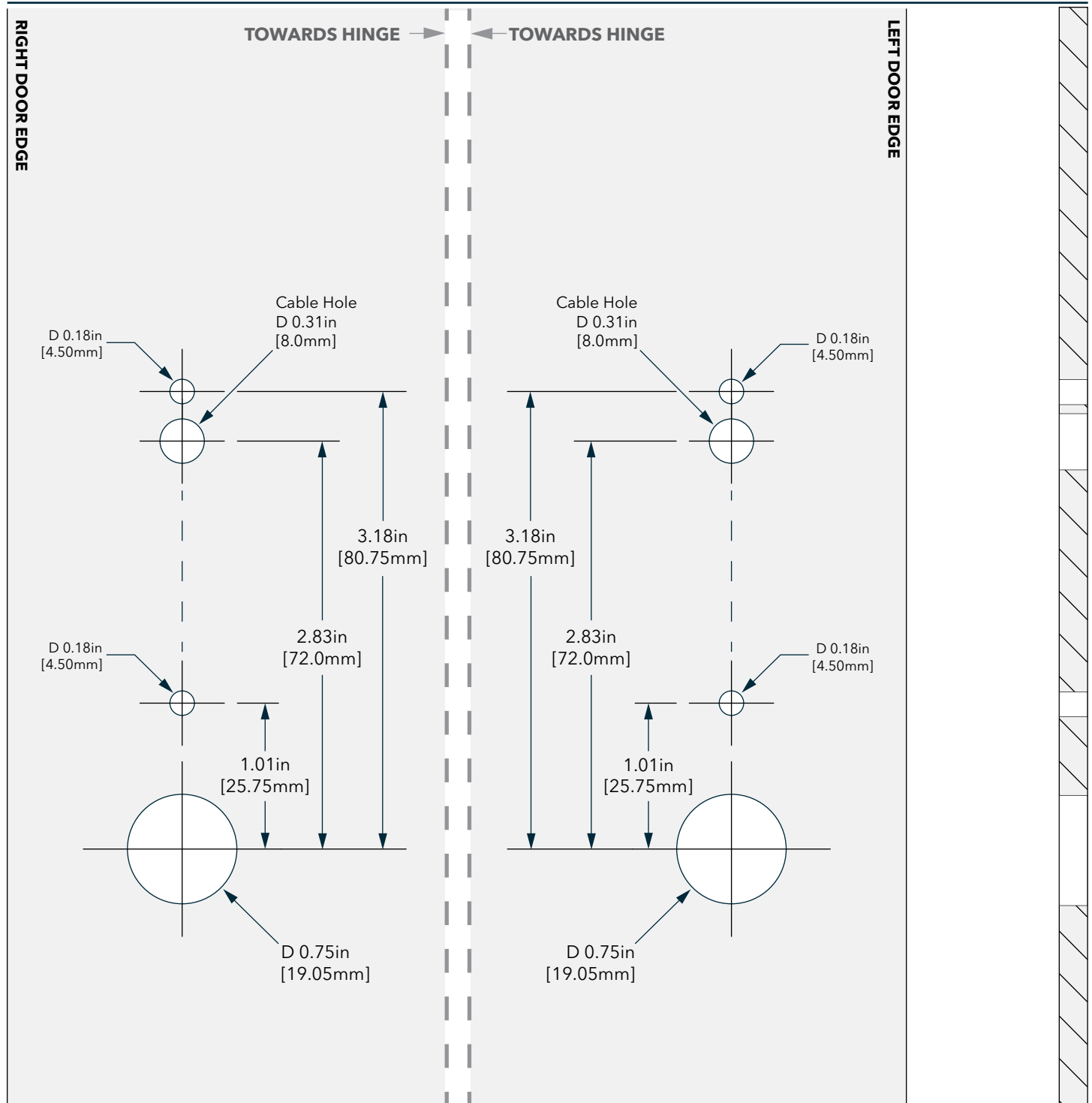
4-HOLE TEMPLATE—CONCEALED PLATE**Recommended Tools for Installation (*Not Included)****NOTE: PRINT TEMPLATE AT 100%**

1 - Phillips Driver (#1)*

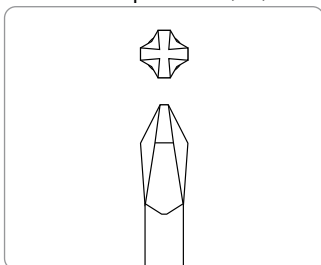

1 - Phillips Driver (#0)*

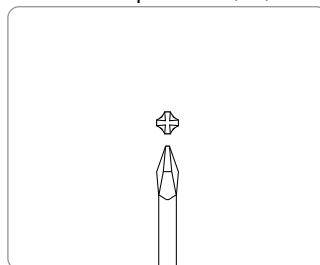

1 - 15/16" Deep Socket Driver*

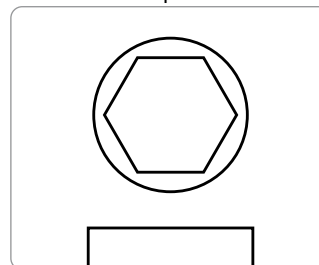

1 - Adjustable Wrench*

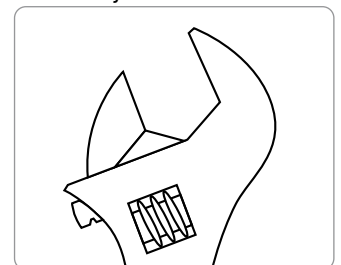

RECESS KEYPAD INSTALLATION

Recess Mount: For Door Thickness less than 10mm

Required Components

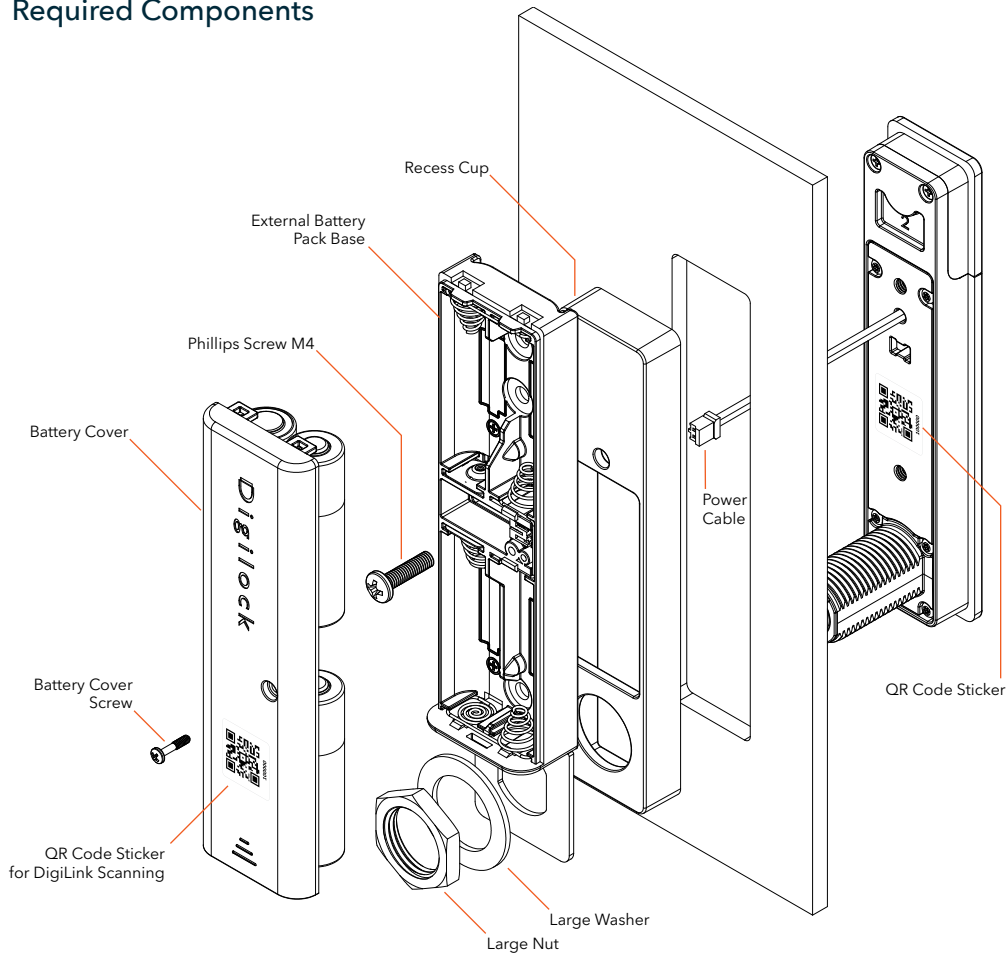

Power Cable Connection

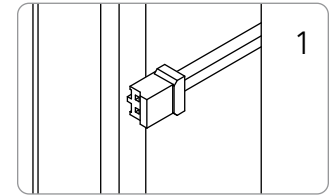

Pull the power cable through the door opening as shown.

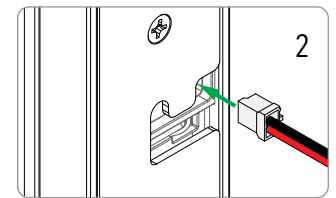

Insert through the rear opening of the battery base as shown.

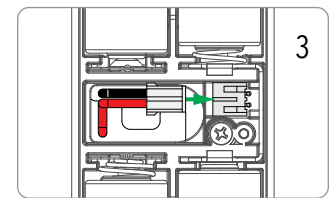

Connect the power cable as shown above.

Front View

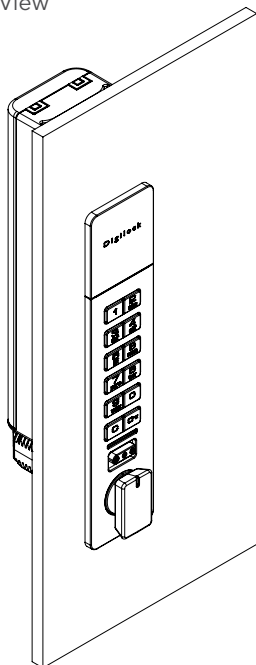

Side View

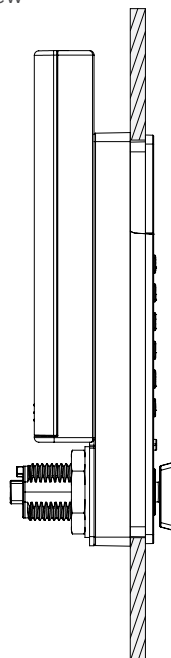

Rear View

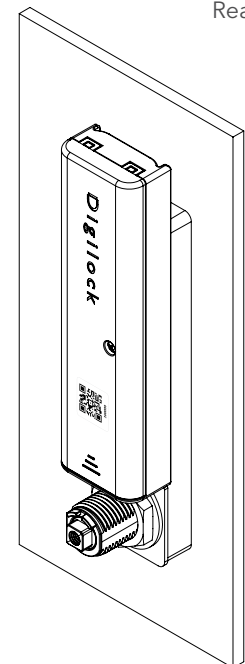

See Cam Guide for Cam Installation

RECESS MORTISE TEMPLATE

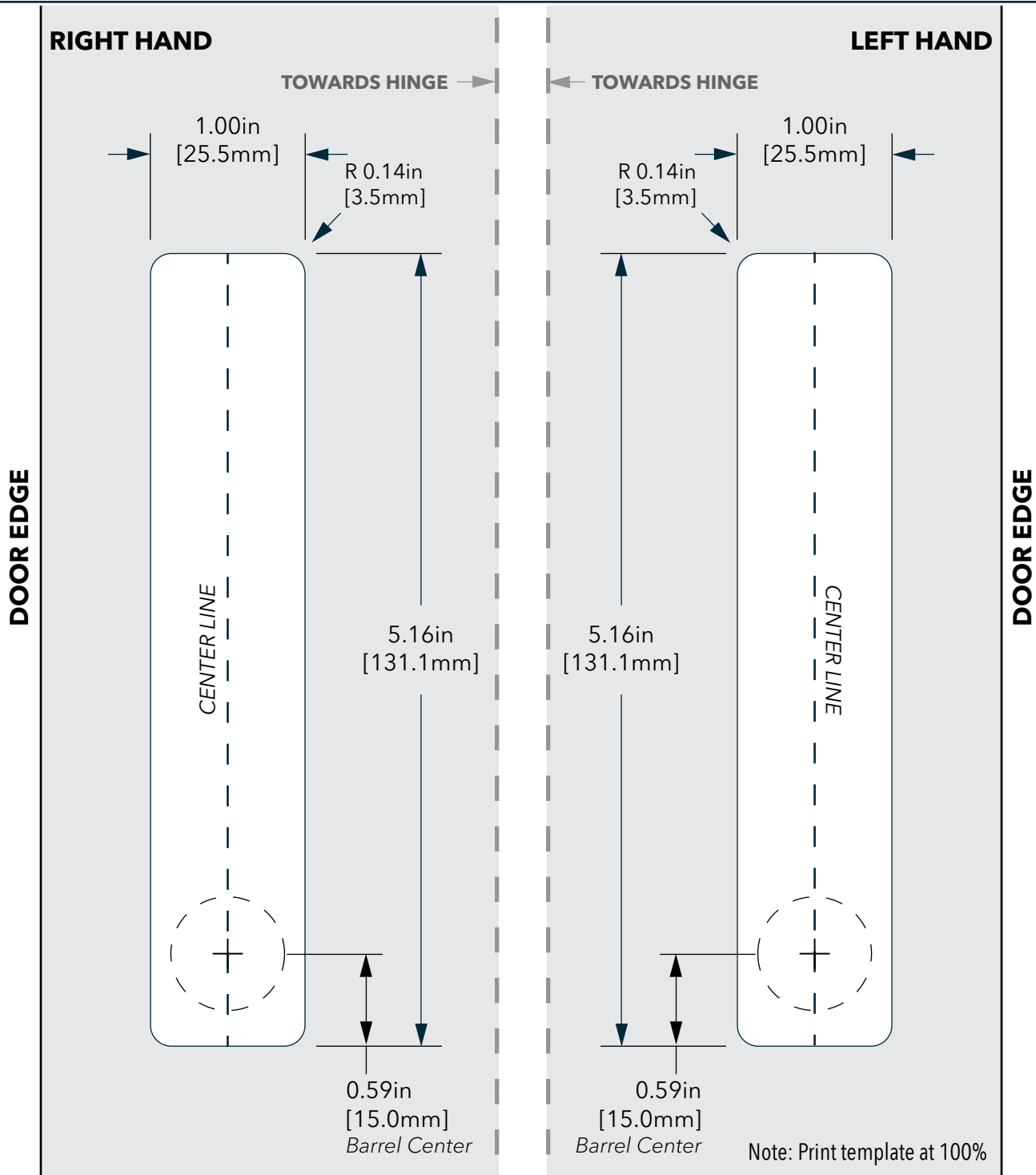

Recommended Tools for Installation (*Not Included)

1 - Phillips Driver (#1)*

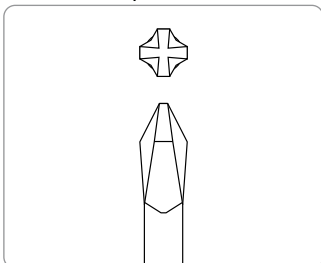

1 - Phillips Driver (#0)*

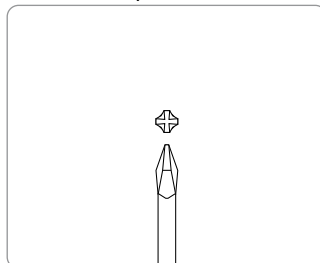

1 - 15/16" Deep Socket Driver*

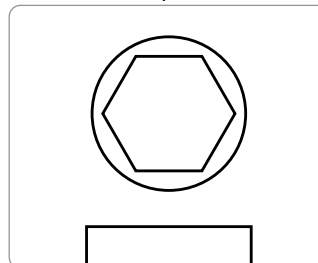

1 - Adjustable Wrench*

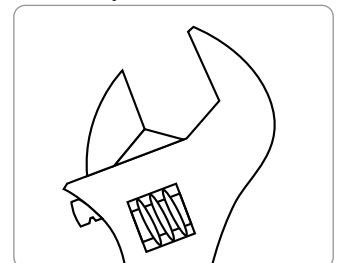

RECESS KEYPAD INSTALLATION—CONCEALED PLATE

Recess Mount: For Door Thickness less than 10mm

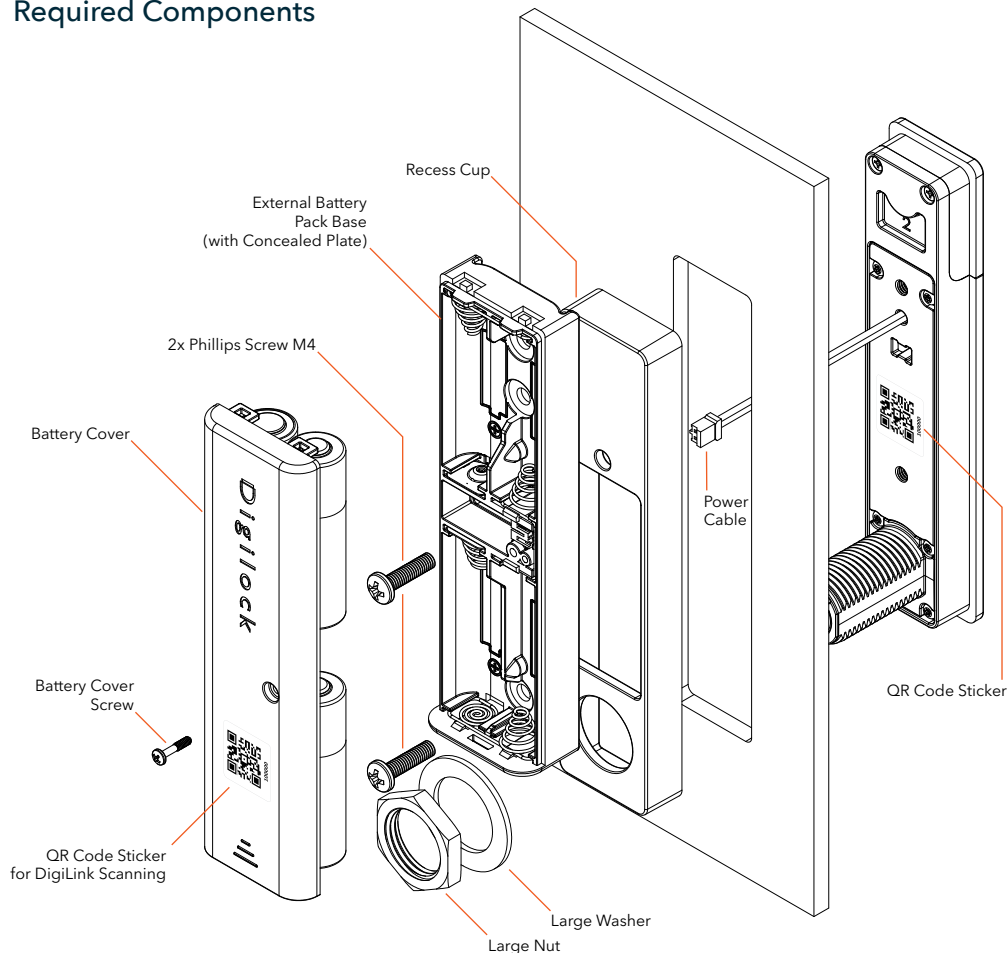
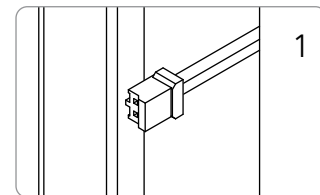
Required Components**Power Cable Connection**

Pull the power cable through the door opening as shown.

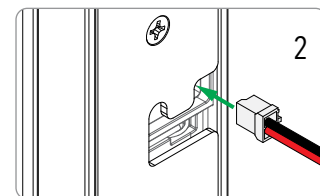

Insert through the rear opening of the battery base as shown.

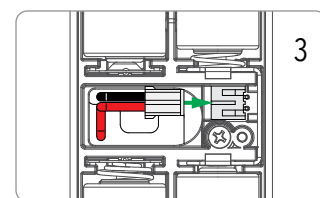

Connect the power cable as shown above.

Front View

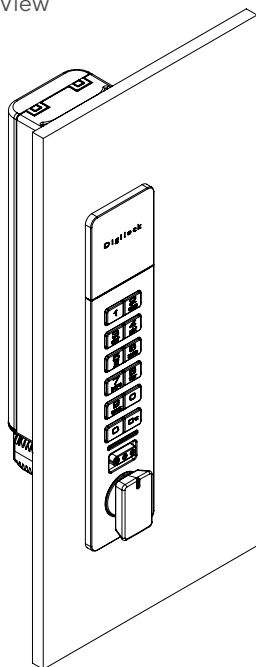

Side View

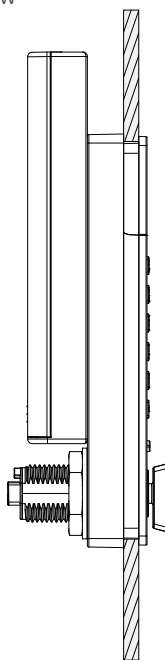

Rear View

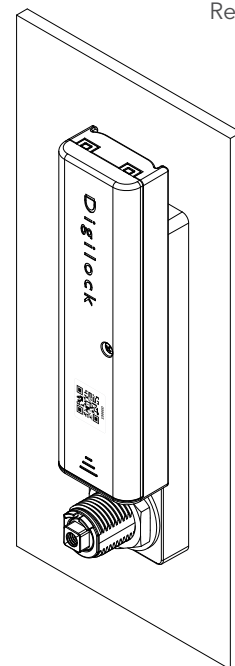

See Cam Guide for Cam Installation

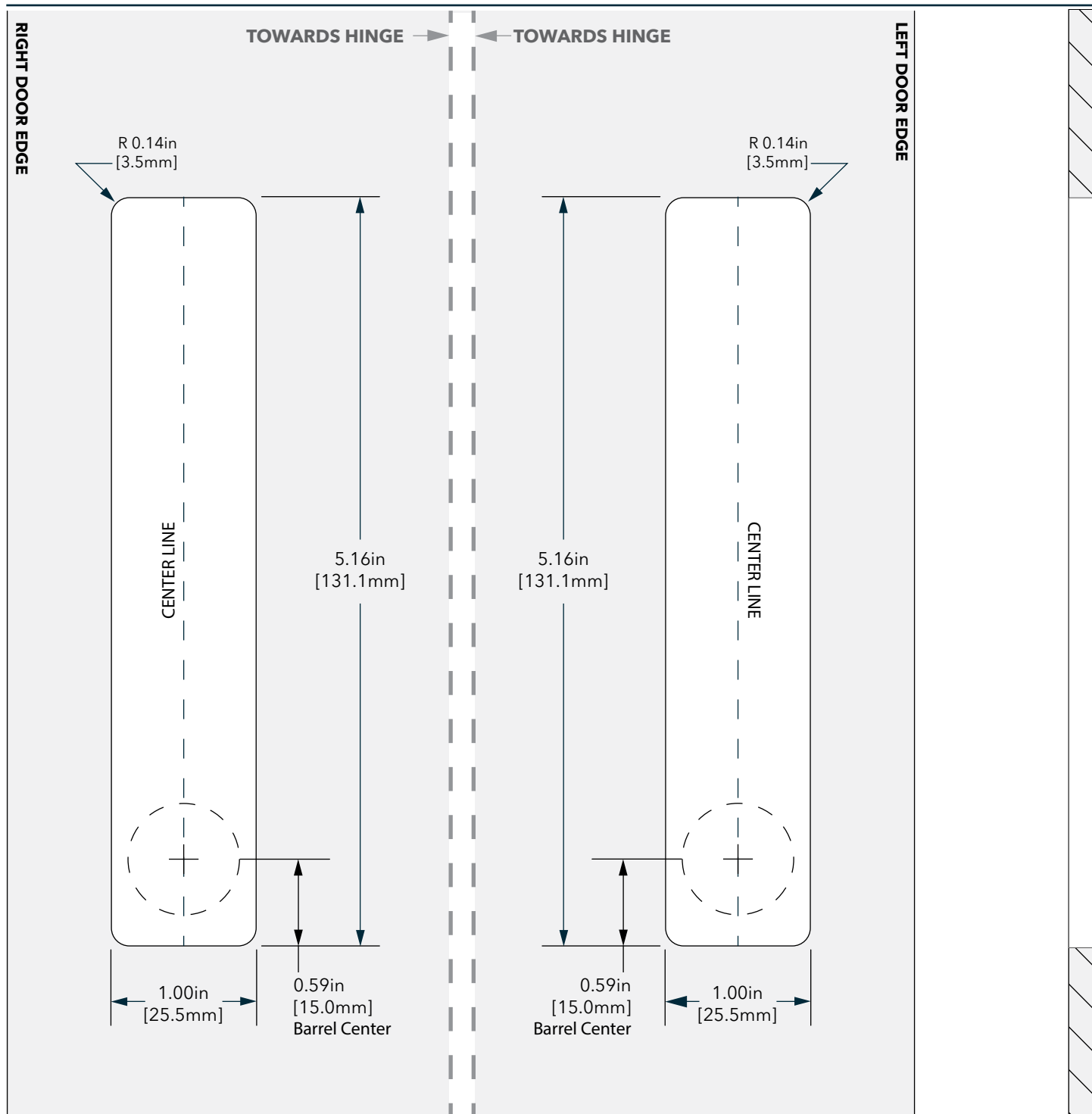
RECESS MORTISE TEMPLATE—CONCEALED PLATE**Recommended Tools for Installation (*Not Included)****NOTE: PRINT TEMPLATE AT 100%**

1 - Phillips Driver (#1)*

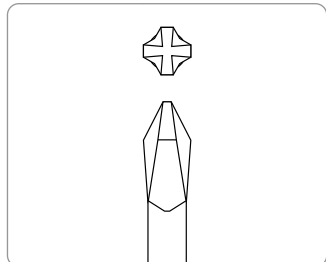

1 - Phillips Driver (#0)*

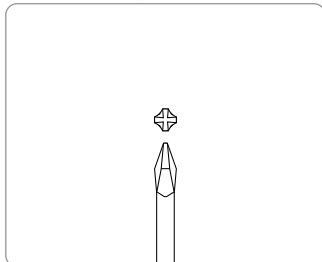

1 - 15/16" Deep Socket Driver*

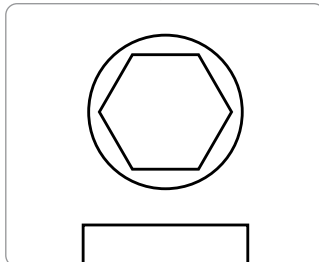

1 - Adjustable Wrench*

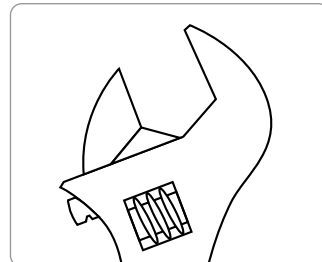

SURFACE RFID INSTALLATION

Surface Mount: For Door Thickness less than 10mm

Required Components

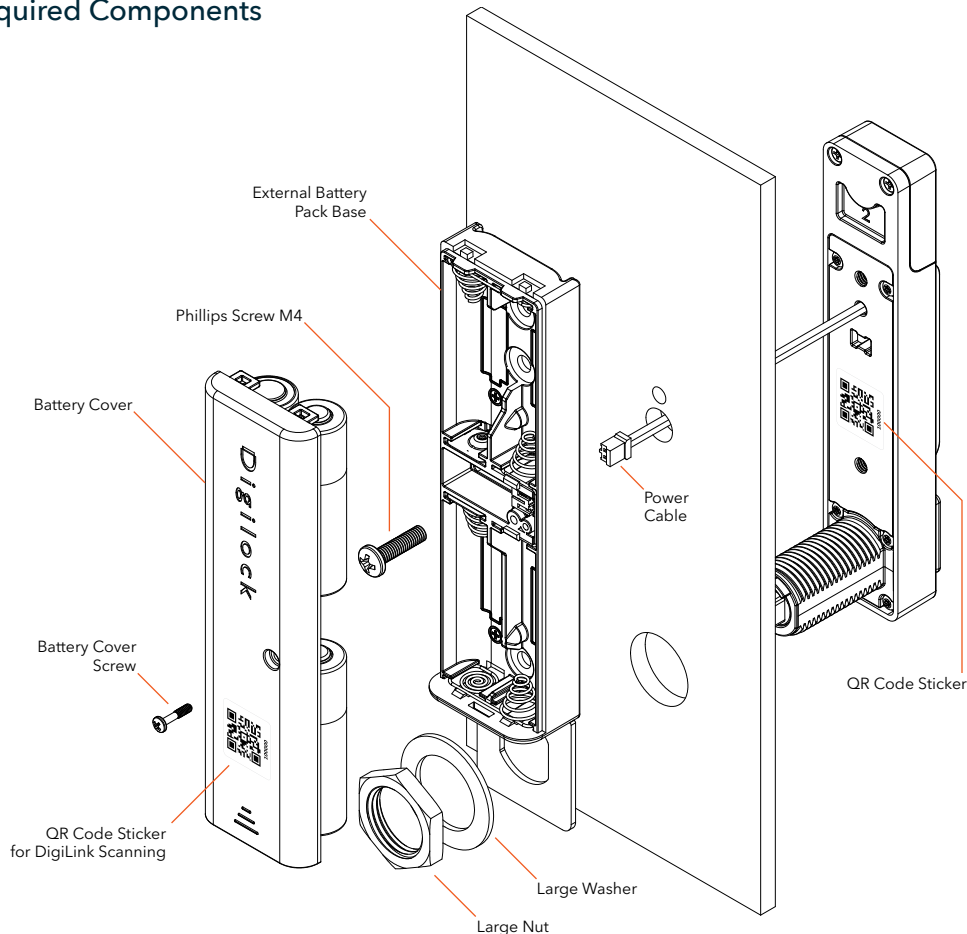

Power Cable Connection

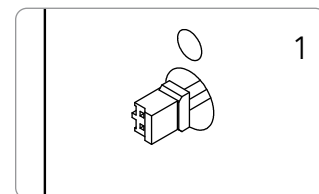

Pull the power cable through the door opening as shown.

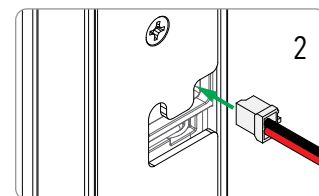

Insert through the rear opening of the battery base as shown.

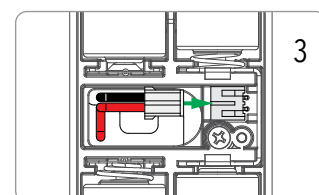

Connect the power cable as shown above.

Front View

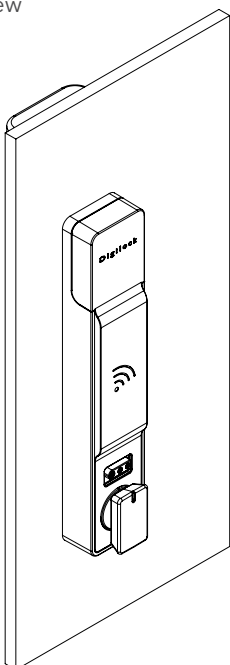

Side View

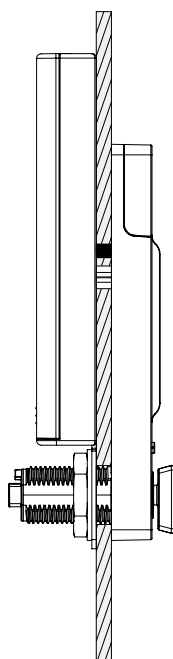

Rear View

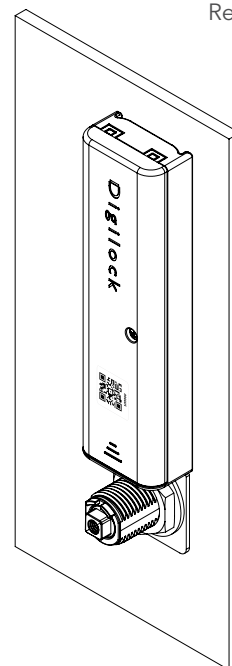

See Cam Guide for Cam Installation

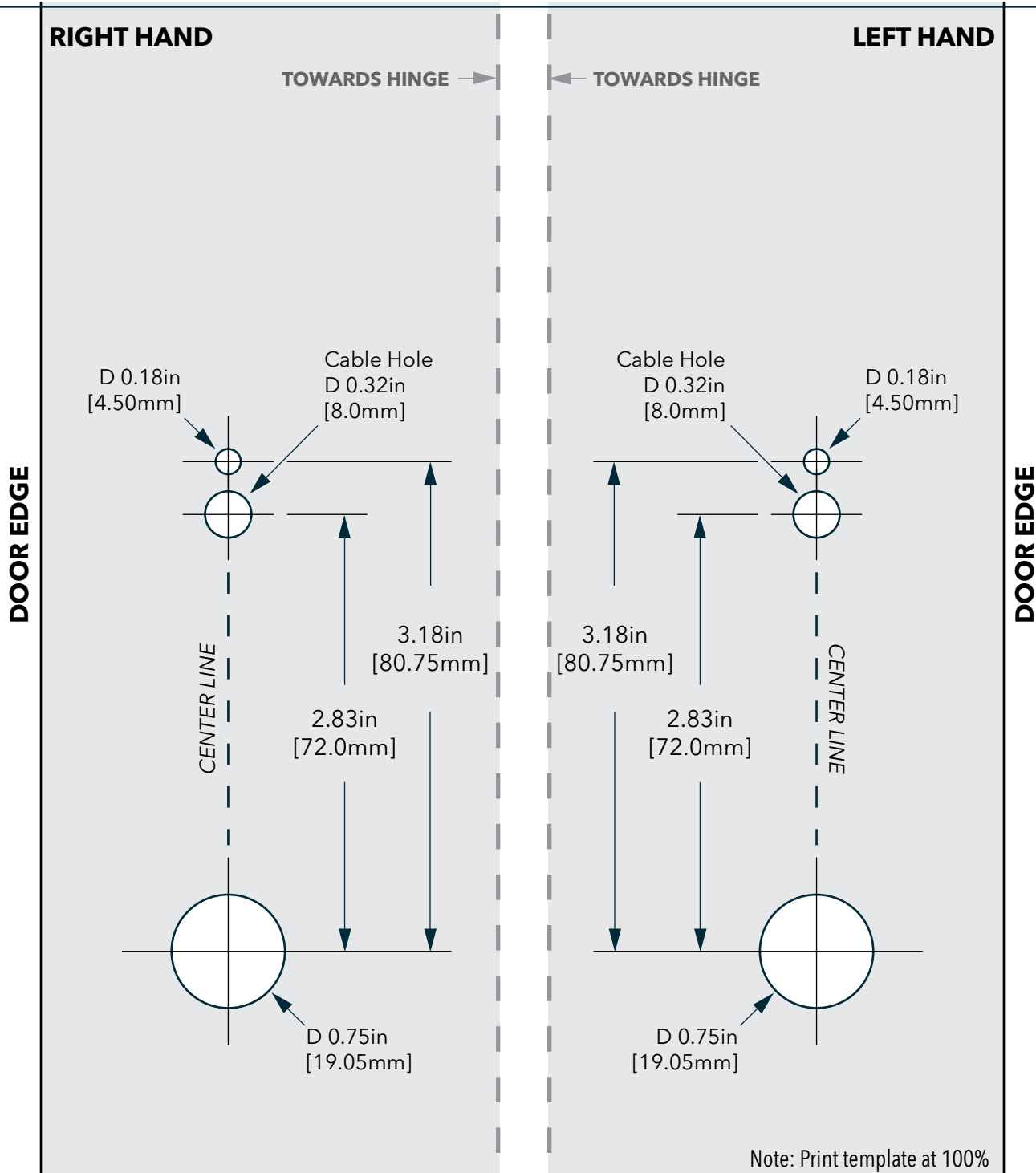
3-HOLE TEMPLATE**Recommended Tools for Installation (*Not Included)**

1 - Phillips Driver (#1)*

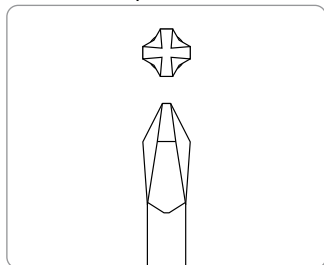

1 - Phillips Driver (#0)*

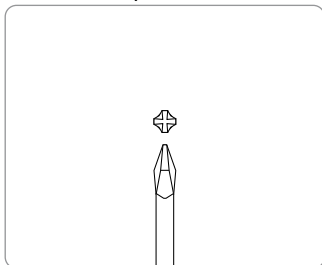

1 - 15/16" Deep Socket Driver*

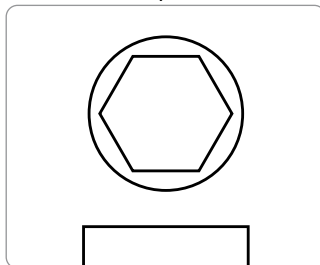

1 - Adjustable Wrench*

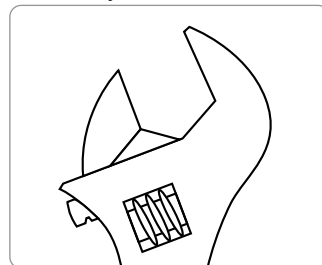

SURFACE RFID INSTALLATION—CONCEALED PLATE

Surface Mount: For Door Thickness less than 10mm

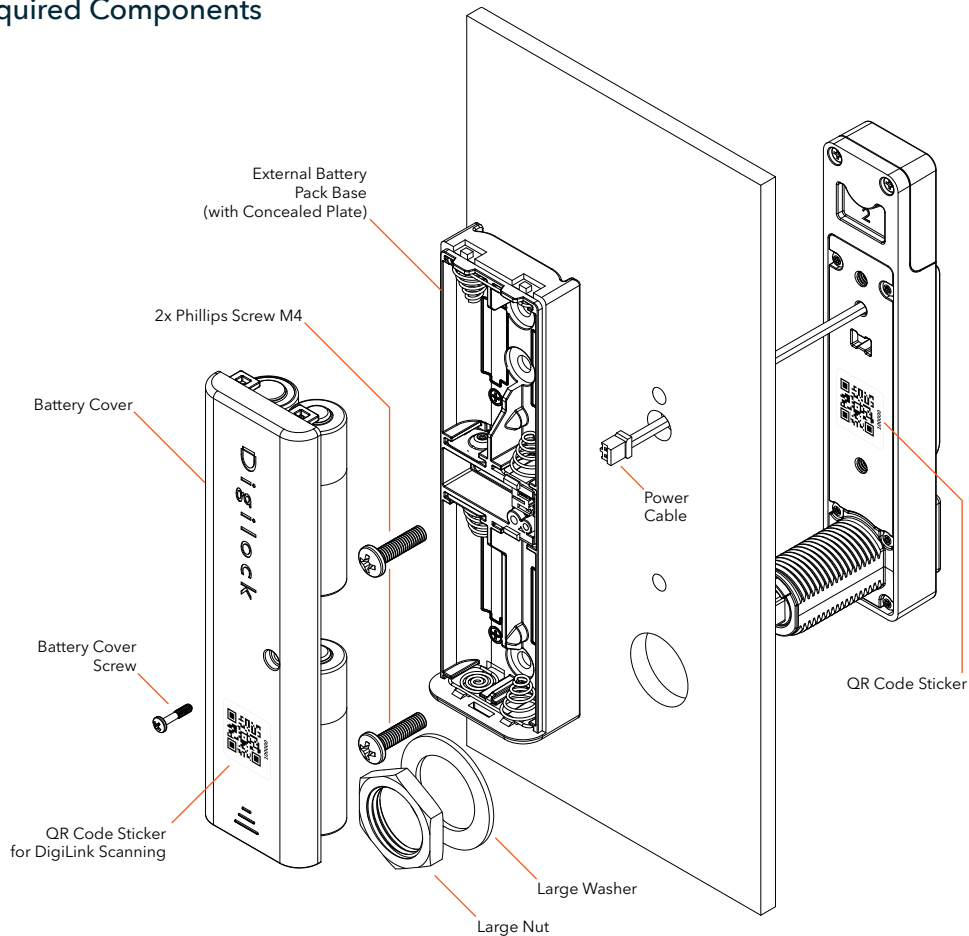
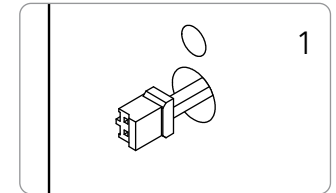
Required Components**Power Cable Connection**

Pull the power cable through the door opening as shown.

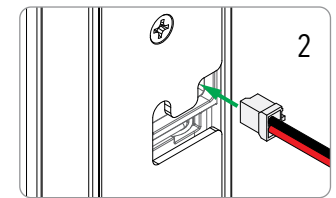

Insert through the rear opening of the battery base as shown.

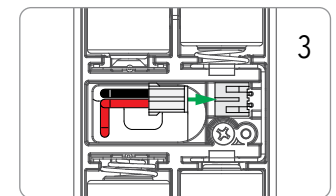

Connect the power cable as shown above.

Front View

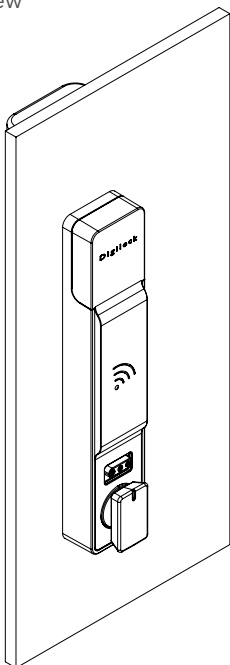

Side View

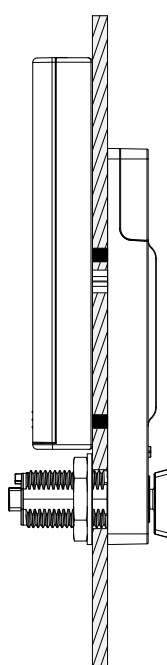

Rear View

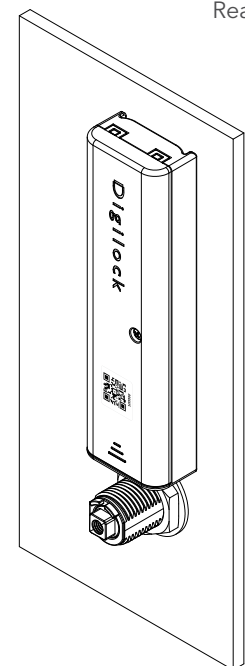
*See Cam Guide for Cam Installation*

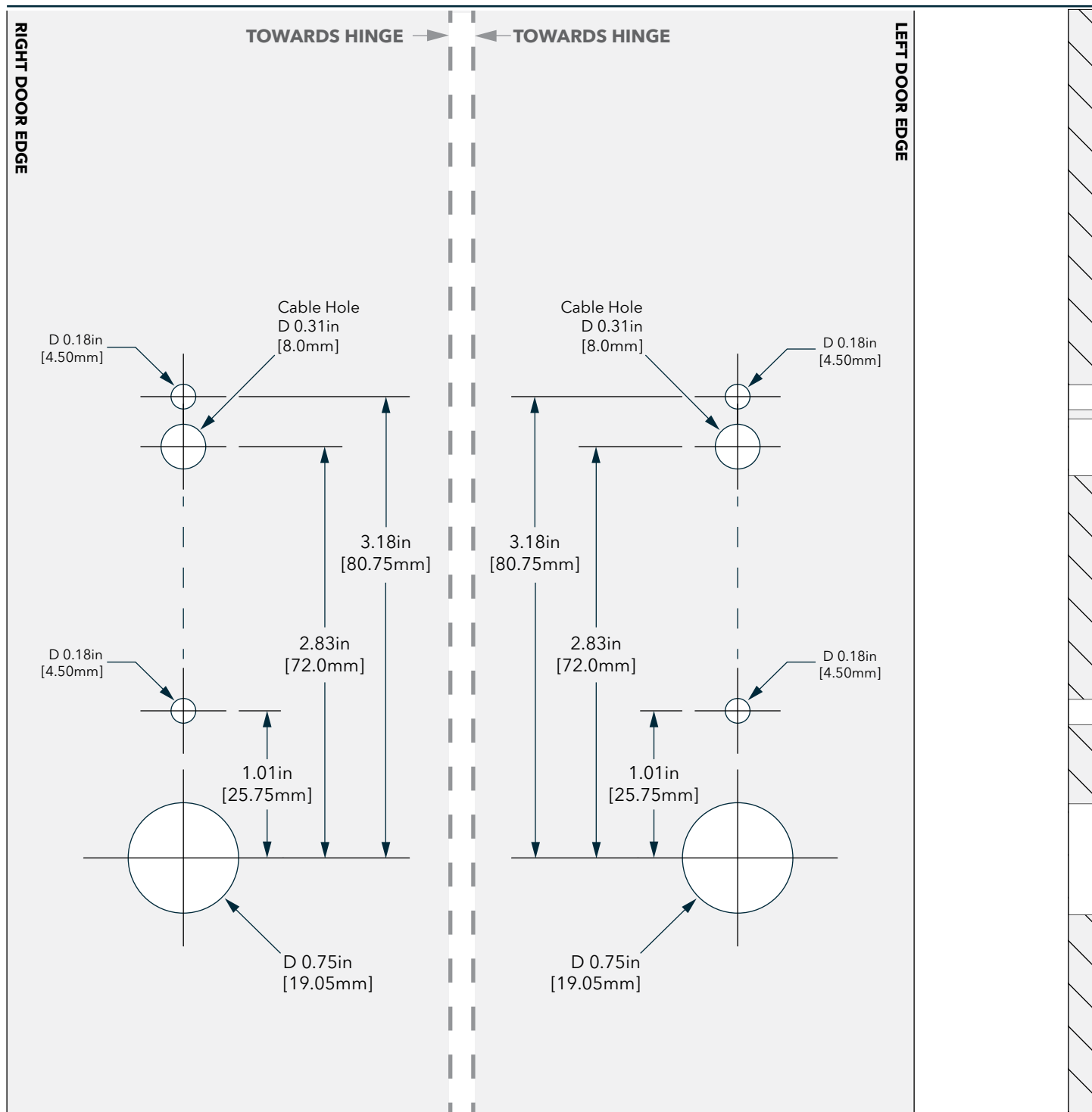
4-HOLE TEMPLATE—CONCEALED PLATE**NOTE: PRINT TEMPLATE AT 100%****Recommended Tools for Installation (*Not Included)**

1 - Phillips Driver (#1)*

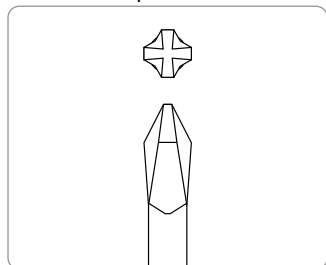

1 - Phillips Driver (#0)*

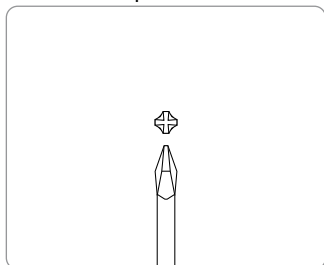

1 - 15/16" Deep Socket Driver*

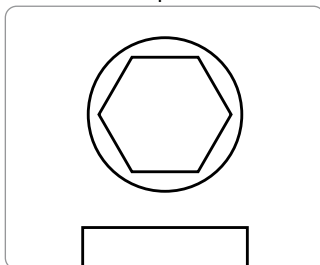

1 - Adjustable Wrench*

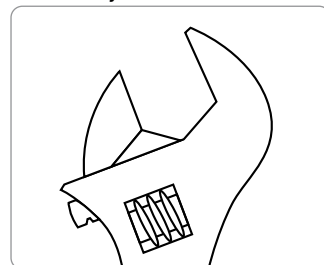

RECESS RFID INSTALLATION

Recess Mount: For Door Thickness less than 10mm

Required Components

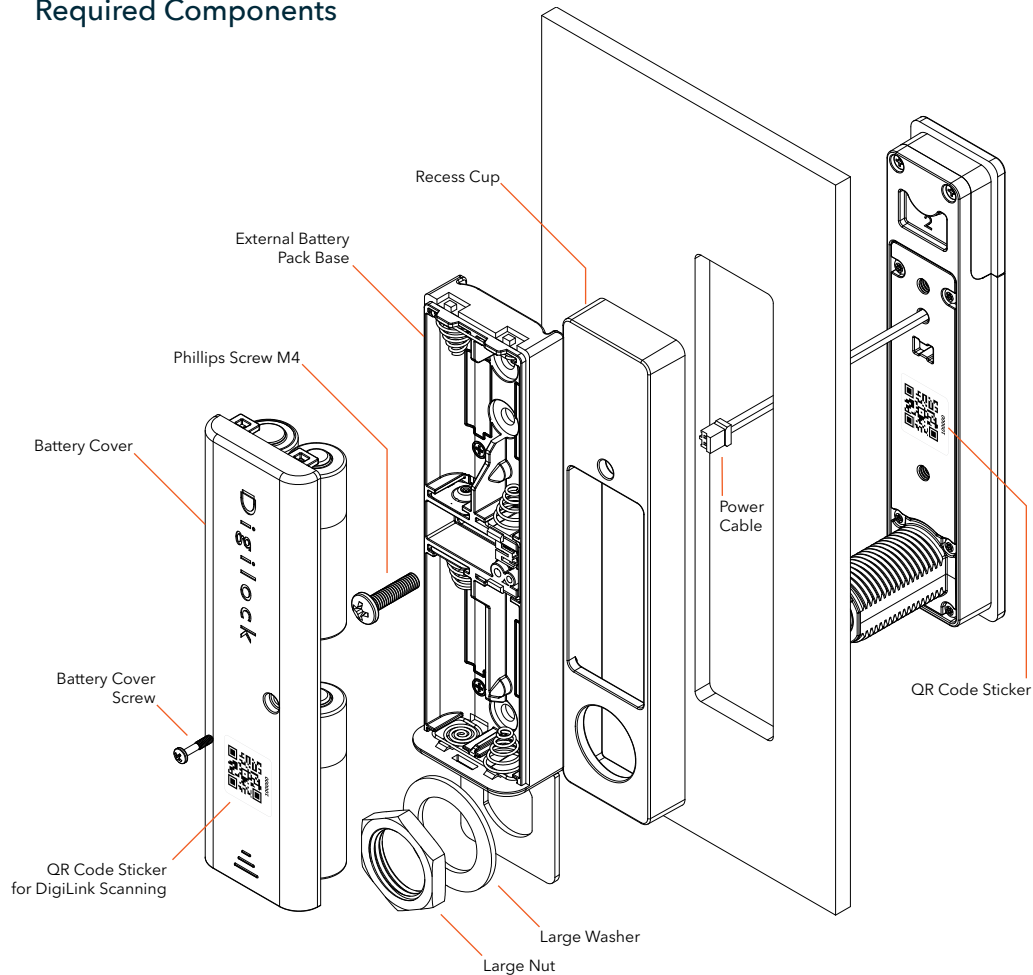

Power Cable Connection

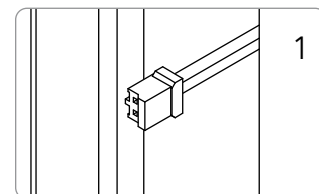

Pull the power cable through the door opening as shown.

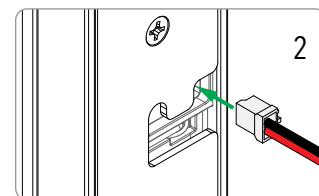

Insert through the rear opening of the battery base as shown.

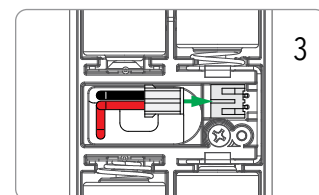

Connect the power cable as shown above.

Front View

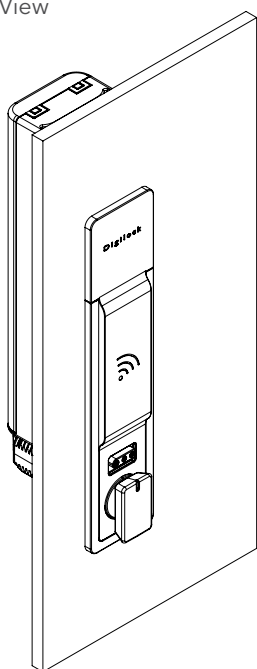

Side View

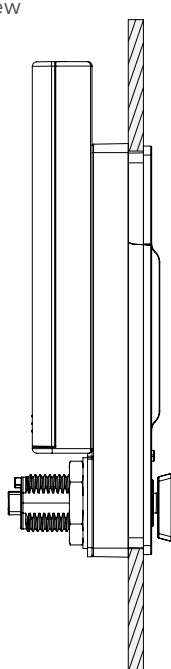

Rear View

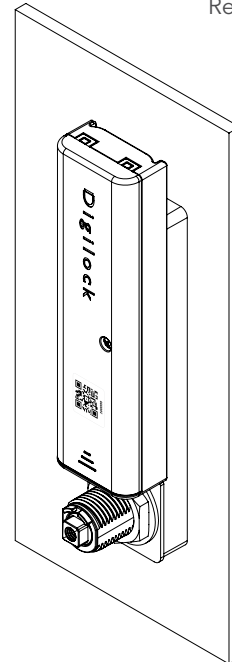

See Cam Guide for Cam Installation

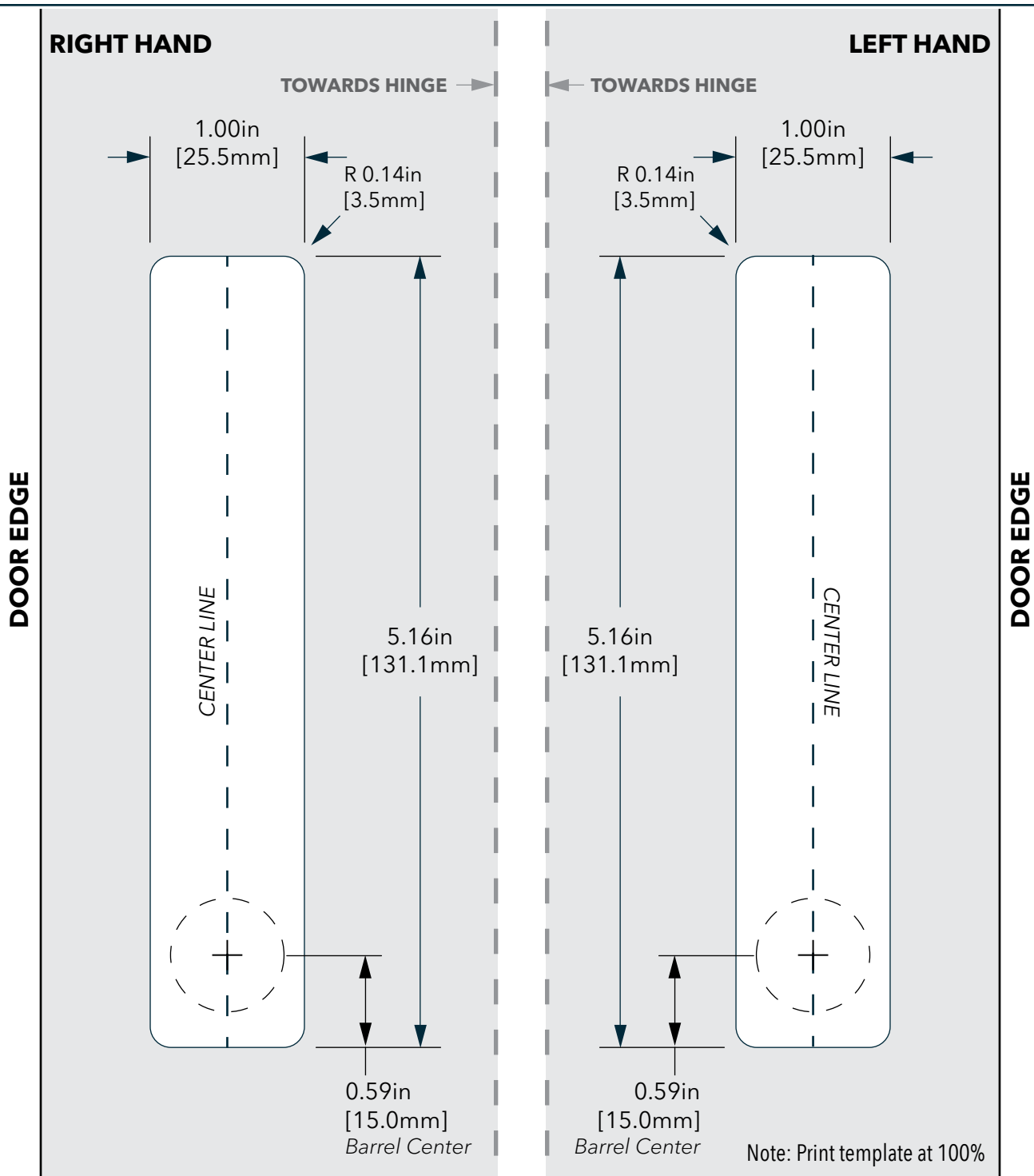
MORTISE TEMPLATE**Recommended Tools for Installation (*Not Included)**

1 - Phillips Driver (#1)*

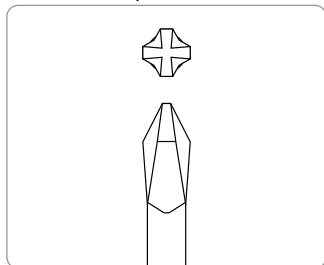

1 - Phillips Driver (#0)*

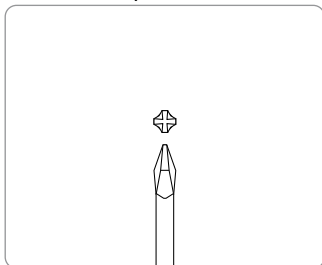

1 - 15/16" Deep Socket Driver*

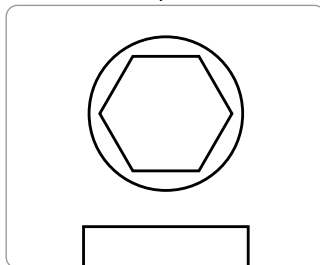

1 - Adjustable Wrench*

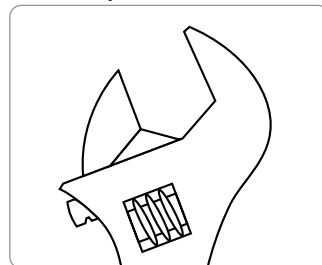

RECESS RFID INSTALLATION—CONCEALED PLATE

Recess Mount: For Door Thickness less than 10mm

Required Components

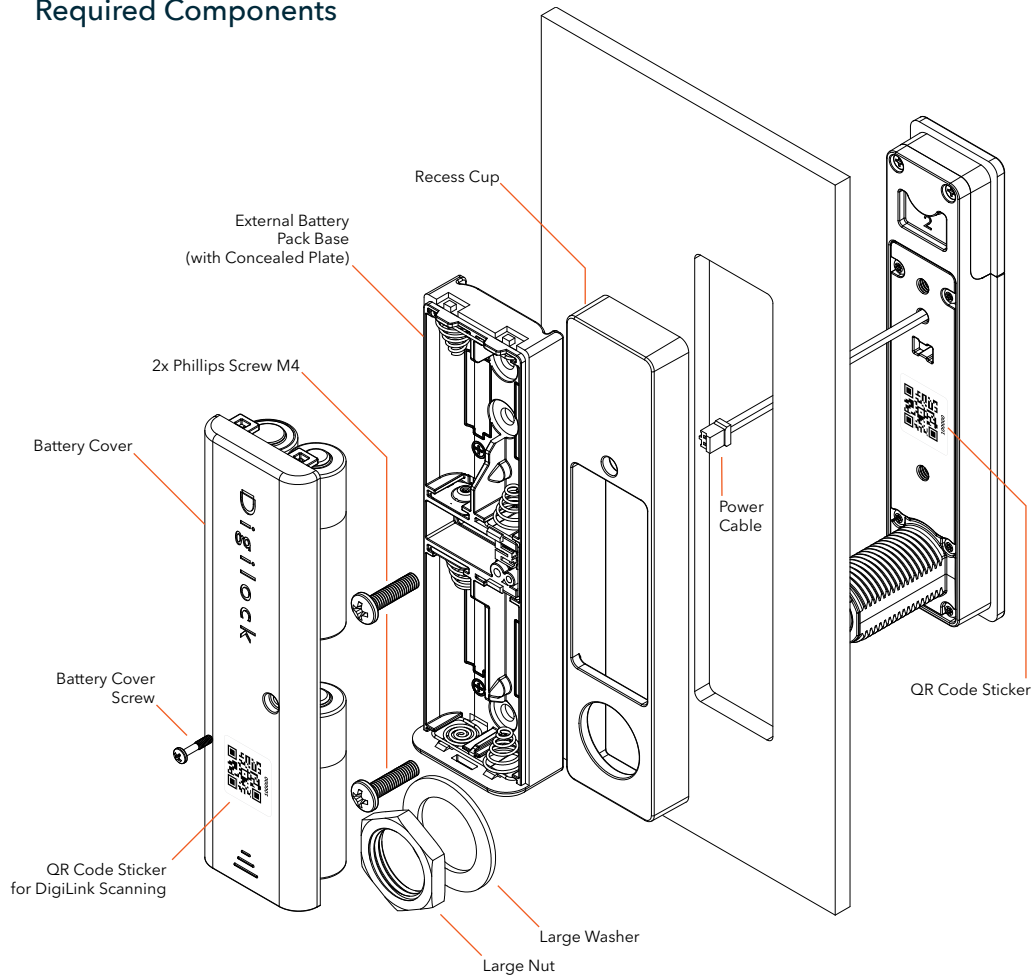

Power Cable Connection

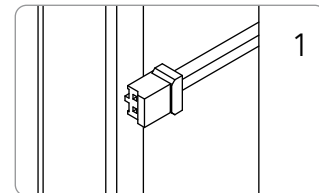

Pull the power cable through the door opening as shown.

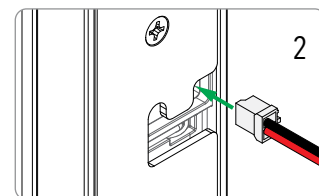

Insert through the rear opening of the battery base as shown.

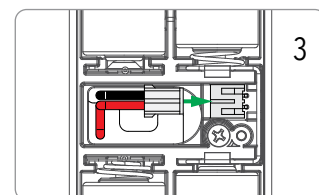

Connect the power cable as shown above.

Front View

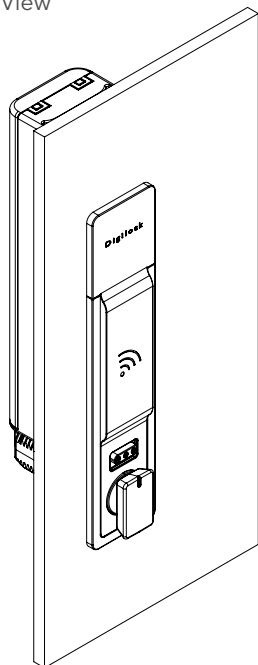

Side View

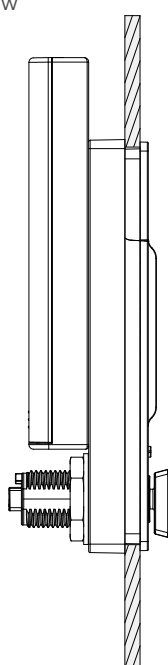

Rear View

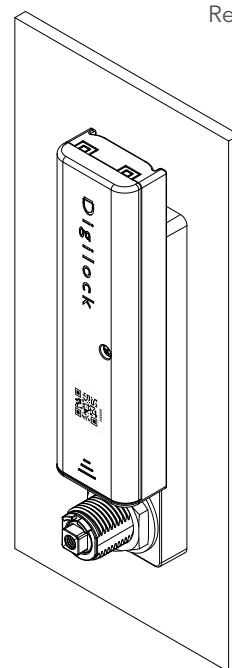

See Cam Guide for Cam Installation

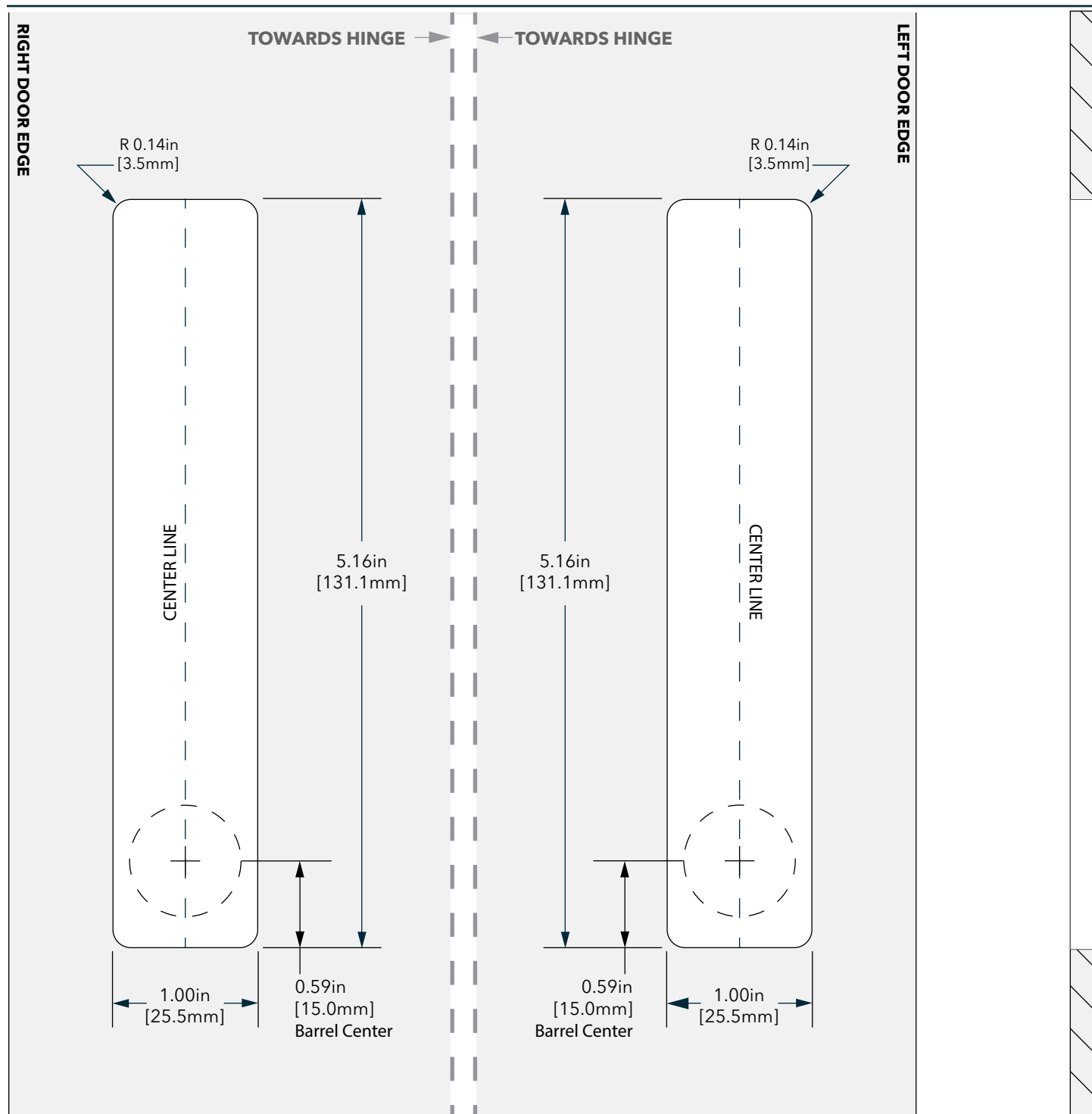
MORTISE TEMPLATE—CONCEALED PLATE**NOTE: PRINT TEMPLATE AT 100%****Recommended Tools for Installation (*Not Included)**

1 - Phillips Driver (#1)*

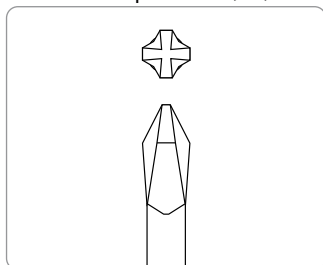

1 - Phillips Driver (#0)*

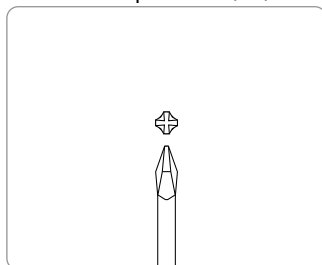

1 - 15/16" Deep Socket Driver*

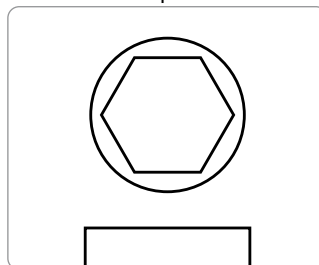

1 - Adjustable Wrench*

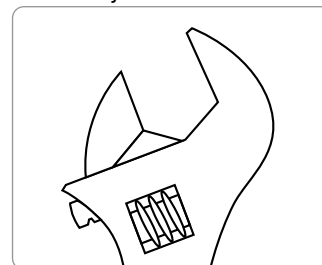

WARRANTY

LIMITED WARRANTY. Company warrants to the original purchaser of Product manufactured by Company to be free of defects in material and workmanship, provided: (1) Company has been notified of such defects within two years of purchase date and been given the opportunity of inspection by return of any alleged defective Product to Company, or its authorized distributor, free and clear of liens, encumbrances, transportation prepaid, accompanied by the statement of defects and proof of purchase; and (2) Product has not been subject to modification, abuse, misuse, mishandling, misapplication, neglect (including but not limited to improper maintenance), accident, improper installation, alteration and/or modification (including but not limited to use of unauthorized parts or attachments), disassembly, or adjustment or repair performed by anyone other than an authorized service personnel during such period; and (3) such defect has not been caused by corrosion or ordinary wear and tear. This warranty does not cover batteries, normal wear and tear of parts and/or damage resulting from any of the following: negligent use or misuse of product, use of improper voltage or current, and/or use contrary to operating instructions. The exclusive remedy shall not be deemed to have failed of its essential purpose so long as Company is willing and able to repair or replace non-conforming Product in the prescribed manner.

Unless the product is listed as IP55 rated or otherwise expressed by Company on the sales order acknowledgement, Product is not designed or intended for exterior use or where exposed to moisture. Any use where Product is exposed to moisture is not covered by any warranties and voids any warranties and any resulting damage caused by direct exterior exposure or moisture is at the Buyer's own risk.

The liability of Company for any breach of the foregoing warranty shall not extend to dismantling, installing or reinstalling, but shall be limited to repairing or replacing said items, as Company's option, within a reasonable time after receipt of written notice from Buyer, within the period of time stipulated herein, of any such non-conforming Product, provided that (i) such notice is given immediately upon the detection of such non-conformance and (ii) such notice is received within the time period stipulated herein. BUYER AND COMPANY EXPRESSLY AGREE THAT THE BUYER'S SOLE AND EXCLUSIVE REMEDY AGAINST COMPANY SHALL BE FOR THE REPAIR OR REPLACEMENT (AT COMPANY'S OPTION) OF NON-CONFORMING PRODUCT AS PROVIDED HEREIN.

COMPANY SPECIFICALLY DISCLAIMS ANY OTHER WARRANTIES, EXPRESS, IMPLIED, OR STATUTORY, INCLUDING WITHOUT LIMITATION THE IMPLIED WARRANTY OF FITNESS FOR A PARTICULAR PURPOSE AND THE IMPLIED WARRANTY OF MERCHANTABILITY, AND COMPANY ALSO SPECIFICALLY DISCLAIMS ANY LIABILITY FOR CONSEQUENTIAL OR INCIDENTAL DAMAGES. IN NO EVENT SHALL COMPANY BE LIABLE FOR INCIDENTAL OR CONSEQUENTIAL DAMAGES ARISING OUT OF OR IN CONNECTION WITH THIS AGREEMENT (INCLUDING BUT NOT LIMITED TO BREACH OF ANY OBLIGATION IMPOSED ON COMPANY HEREUNDER OR IN CONNECTION HERewith) OR THE USE, STORAGE, DISPOSAL OR HANDLING OF PRODUCT. Consequential damages for purposes hereof shall include, without limitation, loss of use, income or profit, shutdown, slowdown or stoppage of any production line or facility, or losses sustained as the result of injury (including death) to any person, or loss of or damage to property (including without limitation property handled or processed by the use of Product). Buyer shall indemnify Company against all liability, cost or expense which may be sustained by Company on account of any such loss, damage or injury.

Company will not evaluate warranted Product without Buyer obtaining a Return Merchandise Authorization (RMA) number from Company. Such returns must be prominently marked with the RMA number and shipped prepaid.

Company makes no other warranty, and the warranty is limited to the duration of the expressed warranty period as set forth above.

NOTE: Should Product be considered a consumer product as may be covered by the Magnusson Moss Federal Warranty Act, please be advised that: (1) some states do not allow limitations on incidental consequential damages or how long an implied warranty lasts so that the above limitations may not fully apply; (2) this warranty gives specific legal rights, and a buyer may also have other rights which may vary from state to state.

LIMITATION OF LIABILITY. Company's maximum liability for any damages resulting from or caused by Product, whether in contract, tort, or otherwise, is limited to the purchase price of Product. In no event shall Company be liable for any consequential damages of any nature arising from the sale or use of Product, whether in contract, tort or otherwise, by either use or purchase of Product, the user or purchaser agrees to this limit on Company's liability. Company is not responsible for any modification, addition or alteration to Product by others.

Company reserves the right to make changes in designs and specifications or to make additions or improvements on its products without notice and without incurring any obligation to incorporate them on products previously manufactured.

CONTACT INFORMATION
